



T14 EXTENSION



STRAIGHT SHANK EXTENSION

**STRAIGHT SHANK
EXTENSION
ER COLLET CHUCK
T14
MINI NUT**

ER COLLET CHUCK MINI NUT - T14

Quality

- Cylinderiness : 0.005mm (0.0002")
- Case hardness: HRC 56±2
- Seat runout: 0.005mm (0.0002")
- w/ high-balanced nut

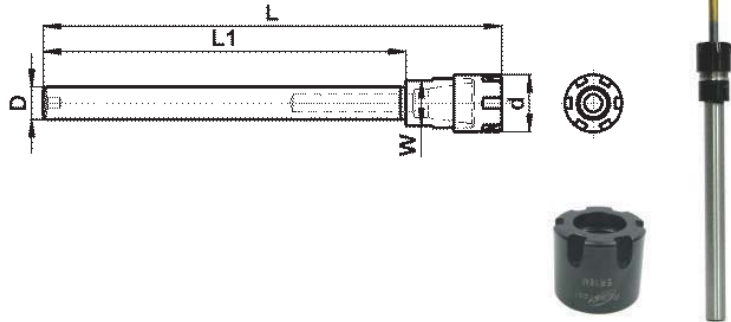

ER COLLET CHUCK MINI NUT METRIC

Order Number	Part Name	Collet	Length	D	d	L	L1	W	Nut
T00T14ER08-08045EM	ER08M 08x021	ER08	45	8	12	45	21	10	Mini
T00T14ER08-08104EM	ER08M 08x080	ER08	104	8	12	104	80	10	Mini
T00T14ER08-10124EM	ER08M 10x100	ER08	124	10	12	124	100	10	Mini
T00T14ER11-12166EM	ER11M 12x140	ER11	166	12	16	166	140	14	Mini
T00T14ER11-16161EM	ER11M 16x140	ER11	161	16	16	161	140	14	Mini
T00T14ER16-12118EM	ER16M 12x080	ER16	118	12	22	118	80	17	Mini
T00T14ER16-16138EM	ER16M 16x100	ER16	138	16	22	138	100	17	Mini
T00T14ER16-20166EM	ER16M 20x140	ER16	166	20	22	166	140	19	Mini
T00T14ER20-16142EM	ER20M 16x100	ER20	142	16	28	142	100	22	Mini
T00T14ER20-25165EM	ER20M 25x140	ER20	165	25	28	165	140	22	Mini

ER COLLET CHUCK MINI NUT INCH

Order Number	Part Name	Collet	Length	D	d	L	L1	W	Nut
T00T14ER08A09124EM	ER08M 3/8"x3.94"	ER08	4.88"	3/8"	0.473"	4.88"	3.94"	3/8"	Mini
T00T14ER11A12166EM	ER11M 1/2"x5.52"	ER11	6.54"	1/2"	0.63"	6.54"	5.51"	9/16"	Mini
T00T14ER11A16158EM	ER11M 5/8"x5.52"	ER11	6.22"	5/8"	0.63"	6.22"	5.51"	9/16"	Mini
T00T14ER16A12177EM	ER16M 1/2"x5.52"	ER16	6.97"	1/2"	0.87"	6.97"	5.51"	11/16"	Mini
T00T14ER16A19165EM	ER16M 3/4"x5.52"	ER16	6.50"	3/4"	0.87"	6.5"	5.51"	11/16"	Mini
T00T14ER20A25168EM	ER20M 1"x5.52"	ER20	6.61"	1"	1.10"	6.61"	5.51"	7/8"	Mini

Order Number Instruction

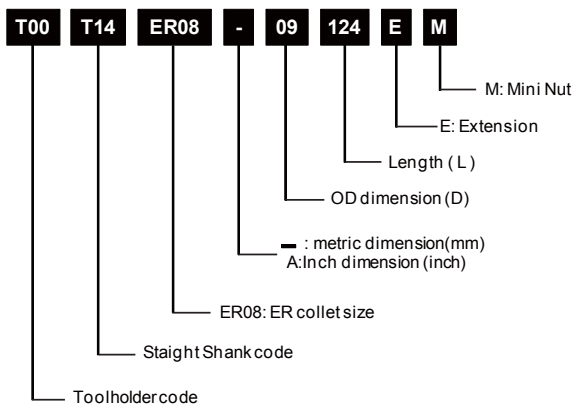

ER COLLET CHUCK - T14

Quality

- Cylinderess : 0.005mm (0.0002")
- Case hardened hardness: HRC 56±2
- Seat runout: 0.005mm (0.0002")
- w/ high-balanced nut

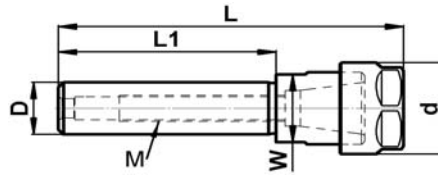

ER COLLET CHUCK METRIC

Order Number	Part Name	Collet	Length	D	d	L	L1	M	W	Nut
T00T14ER11-12134E	ER11 12x100	ER11	134	12	19	134	100	X	17	Hex
T00T14ER11-16174E	ER11 16x140	ER11	174	16	19	174	140	X	17	Hex
T00T14ER16-16096E	ER16 16x060	ER16	96	16	28	96	60	M8	19	Hex
T00T14ER16-20080E	ER16 20x050	ER16	80	20	28	80	50	M12	19	Hex
T00T14ER16-20130E	ER16 20x100	ER16	130	20	28	130	100	M12	19	Hex
T00T14ER16-20190E	ER16 20x160	ER16	190	20	28	190	160	M12	19	Hex
T00T14ER20-20096E	ER20 20x060	ER20	96	20	34	96	60	M12	22	Hex
T00T14ER20-20136E	ER20 20x100	ER20	136	20	34	136	100	M12	22	Hex
T00T14ER32-20104E	ER32 20x050	ER32	104	20	50	104	50	M12	36	Hex
T00T14ER32-20154E	ER32 20x100	ER32	154	20	50	154	100	M12	36	Hex
T00T14ER32-25154E	ER32 25x100	ER32	154	25	50	154	100	M18	36	Hex
T00T14ER40-25097E	ER40 25x050	ER40	97	25	50	97	50	M18	45	Hex

ER COLLET CHUCK INCH

Order Number	Part Name	Collet	Length	D	d	L	L1	M	W	Nut
T00T14ER11A12174E	ER11 1/2"x5.52"	ER11	6.85"	1/2"	0.75"	6.85"	5.52"	X	9/16"	Hex
T00T14ER11A16174E	ER11 5/8"x5.52"	ER11	6.85"	5/8"	0.75"	6.85"	5.52"	X	11/16"	Hex
T00T14ER16A16095E	ER16 5/8"x2.36"	ER16	3.74"	5/8"	1.10"	3.74"	2.36"	5/16"-24	13/16"	Hex
T00T14ER16A19085E	ER16 3/4"x1.97"	ER16	3.35"	3/4"	1.10"	3.35"	1.97"	7/16"-20	13/16"	Hex
T00T14ER16A19135E	ER16 3/4"x3.94"	ER16	5.32"	3/4"	1.10"	5.32"	3.94"	7/16"-20	13/16"	Hex
T00T14ER16A19175E	ER16 3/4"x5.52"	ER16	6.89"	3/4"	1.10"	6.89"	5.52"	7/16"-20	13/16"	Hex
T00T14ER20A19100E	ER20 3/4"x2.5"	ER20	3.94"	3/4"	1.34"	3.94"	2.50"	7/16"-20	15/16"	Hex
T00T14ER20A25180E	ER20 1"x5.52"	ER20	7.09"	1"	1.34"	7.09"	5.52"	9/16"-18	15/16"	Hex
T00T14ER25A25101E	ER25 1"x1.97"	ER25	3.98"	1"	1.65"	3.98"	1.97"	11/16"-16	1-1/2"	Spanner
T00T14ER32A25101E	ER32 1"x1.97"	ER32	3.98"	1"	1.97"	3.98"	1.97"	11/16"-16	1-1/2"	Spanner
T00T14ER32A32111E	ER32 1-1/4"x2.36"	ER32	4.37"	1-1/4"	1.97"	4.37"	2.36"	15/16"-16	1-1/2"	Spanner
T00T14ER40A25125E	ER40 1"x1.97"	ER40	4.92"	1"	2.48"	4.92"	1.97"	11/16"-16	1-7/8"	Spanner

Order Number Instruction

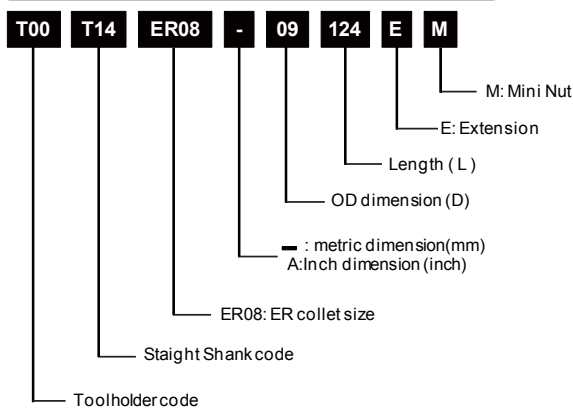



STRAIGHT SHANK EXTENSION

ER COLLET CHUCK CNC LATHE - T14

**STRAIGHT SHANK
EXTENSION
ER COLLET CHUCK
T14
CNC LATHE**

Quality

- Cylinderiness : 0.005mm (0.0002")
- Case hardness: HRC 56±2
- Seat runout: 0.005mm (0.0002")
- w/ high-balanced nut

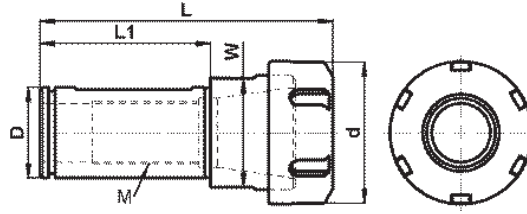

ER COLLET CHUCK MINI NUT METRIC

Order Number	Part Name	Collet	Length	D	d	L	L1	M	W	Nut
T00T14ER25-32092L	ER25 32x60	ER25	92	32	42	92	60	M18	27	Spanner
T00T14ER32-32098L	ER32 32x60	ER32	98	32	50	98	60	M24	36	Spanner
T00T14ER32-40113L	ER32 40x80	ER32	113	40	50	113	80	M24	36	Spanner
T00T14ER40-40130L	ER40 40x75	ER40	130	40	63	130	75	M28	36	Spanner

ER COLLET CHUCK MINI NUT INCH

Order Number	Part Name	Collet	Length	D	d	L	L1	M	W	Nut
T00T14ER25A32097L	ER25 1-1/4"x2.36"	ER25	3.82"	1-1/4"	1.65"	3.82"	2.36"	11/16"-16	1-1/8"	Spanner
T00T14ER32A32103L	ER32 1-1/4"x2.36"	ER32	4.06"	1-1/4"	1.97"	4.06"	2.36"	15/16"-16	1-1/2"	Spanner
T00T14ER32A38118L	ER32 1-1/2"x3.15"	ER32	4.65"	1-1/2"	1.97"	4.65"	3.15"	15/16"-16	1-1/2"	Spanner
T00T14ER40A32120L	ER40 1-1/4"x2.36"	ER40	4.72"	1-1/4"	2.48"	4.72"	2.36"	15/16"-16	1-7/8"	Spanner
T00T14ER40A38135L	ER40 1-1/2"x2.95"	ER40	5.31"	1-1/2"	2.48"	5.31"	2.95"	1-1/8"-16	1-7/8"	Spanner

Order Number Instruction

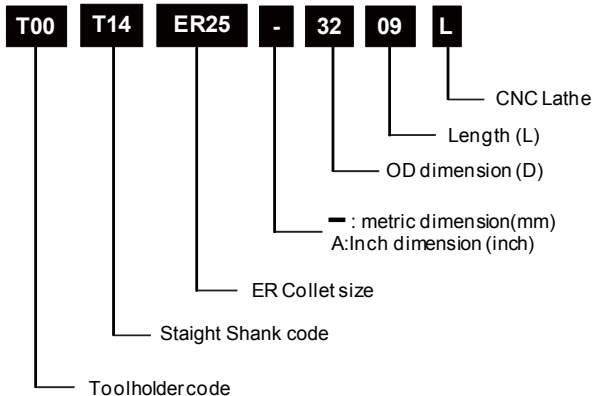



STRAIGHT SHANK EXTENSION

ER COLLET CHUCK CNC LATHE - T14

**STRAIGHT SHANK
EXTENSION
ER COLLET CHUCK
T14
CNC LATHE w/pipe thread**

Quality

- Cylinderiness : 0.005mm (0.0002")
- Case hardened hardness: HRC 56±2
- Seat runout: 0.005mm (0.0002")
- w/ high-balanced nut

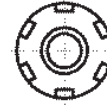
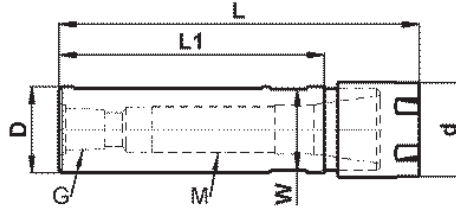

ER COLLET CHUCK CNC LATHE - PIPE THREAD - COOLANT THRU - METRIC

Order Number	Part Name	Collet	Length	D	d	L	L1	G	M	W	Nut
T00T14ER11-16059FM	ER11M 16x38	ER11	59	16	16	59	38	1/4"	M8	14	Mini
T00T14ER11-16161FM	ER11M 16x140	ER11	161	16	16	161	140	1/4"	M8	14	Mini
T00T14ER16-16096FM	ER16M 16x70	ER16	96	16	22	96	70	1/4"	M8	17	Mini
T00T14ER16-20096FM	ER16M 20x70	ER16	96	20	22	96	70	1/4"	M12	17	Mini
T00T14ER16-20126FM	ER16M 20x100	ER16	126	20	22	126	100	1/4"	M12	17	Mini
T00T14ER16-20166FM	ER16M 20x140	ER16	166	20	22	166	140	1/4"	M12	17	Mini
T00T14ER16-22096FM	ER16M 22x70	ER16	96	22	22	96	70	1/4"	M12	19	Mini
T00T14ER20-22108FM	ER20M 22x80	ER20	108	22	28	108	80	1/4"	M12	19	Mini
T00T14ER20-25128FM	ER20M 25x100	ER20	128	25	28	128	100	1/4"	M14	22	Mini
T00T14ER20-25178FM	ER20M 25x150	ER20	178	25	28	178	150	1/4"	M14	22	Mini
T00T14ER32-32115F	ER32 32x60	ER32	115	32	50	115	60	1/4"	M24	38	Spanner

ER COLLET CHUCK CNC LATHE - PIPE THREAD - COOLANT THRU - INCH

Order Number	Part Name	Collet	Length	D	d	L	L1	G	M	W	Nut
T00T14ER16A19110FM	ER16M 3/4"x3.42"	ER16	4.19"	3/4"	0.87"	4.19"	3.42"	1/4"	7/16"-20	11/16"	Mini
T00T14ER20A25111FM	ER20M 1"x3.31"	ER20	4.18"	1"	1.10"	4.18"	3.31"	1/4"	9/16"-18	15/16"	Mini
T00T14ER32A32115F	ER32 1-1/4"x2.36"	ER32	4.33"	1-1/4"	1.97"	4.33"	2.36"	1/4"	15/16"-16	1-1/2"	Spanner

Order Number Instruction

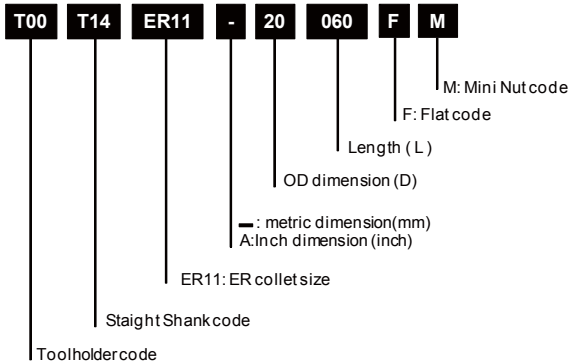



STRAIGHT SHANK EXTENSION

STRAIGHT SHANK

EXTENSION

ER COLLET CHUCK

T14

CNC LATHE - DOUBLE END

ER COLLET CHUCK DOUBLE END - T14

Quality

- Cylinderness : 0.005mm (0.0002")
- Case hardness: HRC 56±2
- Seat runout: 0.005mm (0.0002")
- w/ high-balanced nut

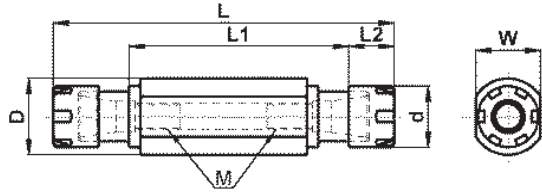

ER COLLET CHUCK DOUBLE END - SWISS CNC MACHINES METRIC

Order Number	Part Name	Collet	Length	D	d	L	L1	M	W	Nut
T00T14ER11-20070SM	ER11M 20x30	ER11	70	20	16	70	30	M8	17	Mini
T00T14ER11-20090SM	ER11M 20x50	ER11	90	20	16	90	50	M8	17	Mini
T00T14ER16-20107SM	ER16M 20x55	ER16	107	20	22	107	55	M12	17	Mini
T00T14ER16-22111SM	ER16M 22x55	ER16	111	22	22	111	55	M12	19	Mini
T00T14ER16-22131SM	ER16M 22x75	ER16	131	22	22	131	75	M12	19	Mini

ER COLLET CHUCK DOUBLE END - SWISS CNC MACHINES INCH

Order Number	Part Name	Collet	Length	D	d	L	L1	M	W	Nut
T00T14ER11A19078SM	ER11M 3/4"x1.73"	ER11	3.06"	3/4"	0.63"	3.06"	1.73"	M8	17	Mini
T00T14ER11A19099SM	ER11M 3/4"x2.56"	ER11	3.88"	3/4"	0.63"	3.88"	2.56"	M8	17	Mini
T00T14ER11A19111SM	ER11M 3/4"x3.03"	ER11	4.35"	3/4"	0.63"	4.35"	3.03"	M8	17	Mini
T00T14ER11A19133SM	ER11M 3/4"x3.92"	ER11	5.24"	3/4"	0.63"	5.24"	3.92"	M8	17	Mini

Order Number Instruction

