



# CAT40 & CAT50 Rotating Tool Holders



SOLD IN NORTH AMERICA BY ON TARGET TOOLING LLC



Taper, faces and V-flange are ground in a single process

ID bore taper, faces and thread are ground in a single process on Studer Multitask CNC Grinders

Pre-Balanced ER collet nut design

Taper Angle Tolerance :AT3+ or better  
100% dimension check using high precision in-process measuring systems

Seating Runout:0.00012"( 0.003mm)

4D Runout w/AA collet:0.0002"( 0.005mm)  
4D Runout w/A collet:0.00039"( 0.010mm)

PrimeTool toolholders are manufactured using state-of-the-art technology and the latest HSM concepts.

- Taper Angle Tolerance:  $\pm 0.003\text{mm}$
- Case Hardened: HRC  $58 \pm 2$
- Seat Runout: 0.005mm for End Mill Holder, Shell Milling Holder  
0.003mm for ER Collet Chuck, Screw In Holder, Slim Collet Chuck, Shrink Fit
- Balance: G2.5, 25,000 rpm \*Option to G2.5, 40,000 rpm

**B-Type(Flange through coolant)**

\*DIN Form B holders are stocked with axial coolant setting. Convert to flange coolant by removing set screws.

Taper	d1	d2	d3	d4	a	L1	f2	f3	b	B1	B2	G	E1	E2
CAT40	44.45	44.45	63.55	18	3.18	68.25	35	19.05	16.38	24.8	22.41	5/8"-11	4	27
CAT50	69.85	69.85	98.48	28	3.18	101.6	35	19.05	25.9	37.7	35.3	1"-8	4	42

Example: T00CA40020-16063A, CAT40 ER16-063

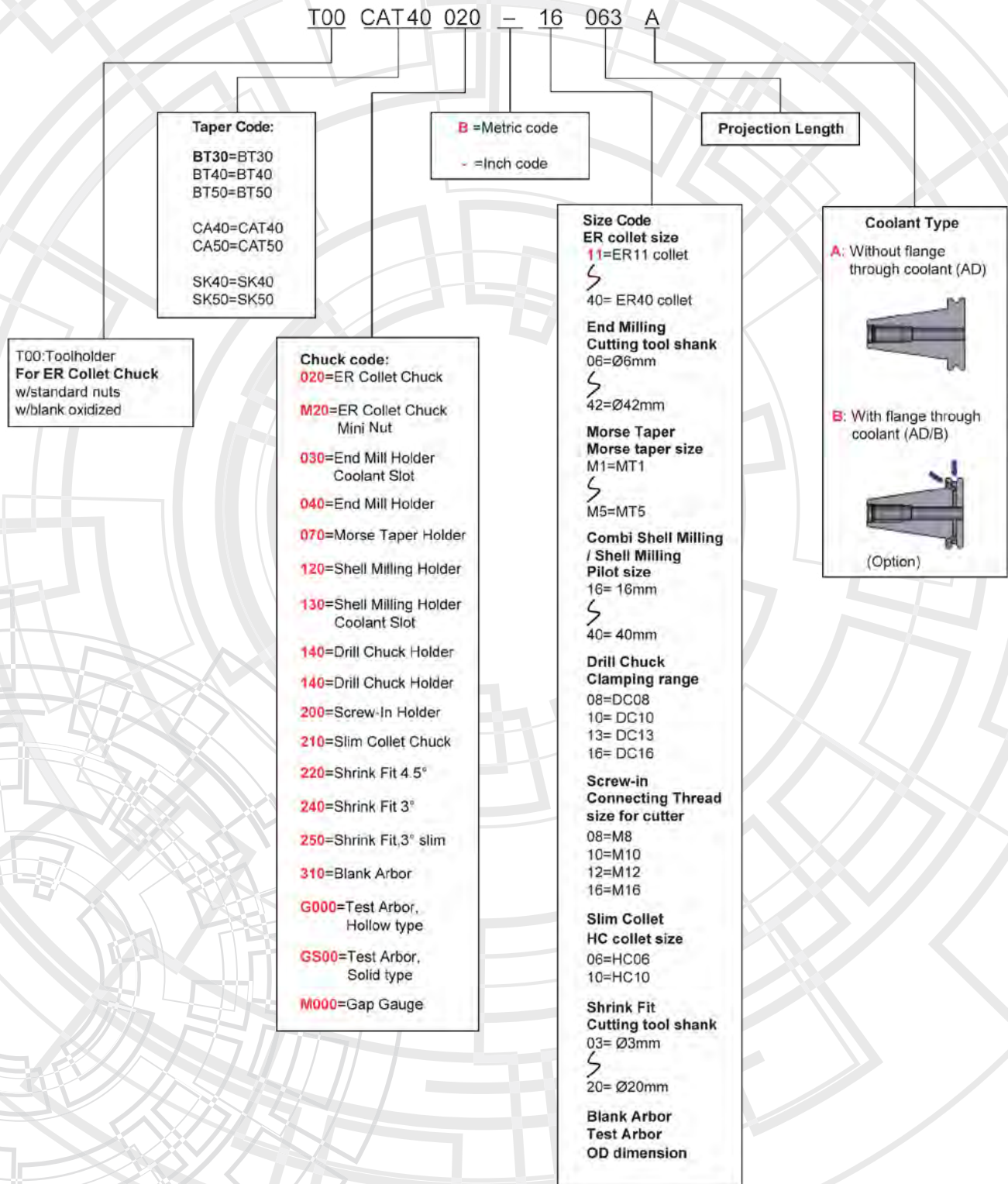



## CAT40

Page 5	ER Collet Chuck - Standard Nut
Page 6	ER Collet Chuck - Mini Nut
Page 7	Slim Collet Chuck / HC Collets
Page 8	Screw In Holder
Page 9	End Mill Holder
Page 10	End Mill Holder - with Coolant Slots
Page 11	Shell Mill Holder & Coolant Fed
Page 12	Shrink Fit Holder 4.5° - Inch Sizes
Page 13	Shrink Fit Holder 4.5° - Metric Sizes

## CAT50

Page 14	ER Collet Chuck - Standard Nut
Page 15	ER Collet Chuck - Mini Nut
Page 16	Slim Collet Chuck / HC Collets
Page 17	Screw In Holder
Page 18	End Mill Holder
Page 19	End Mill Holder - with Coolant Slots
Page 20	Shell Mill Holder
Page 21	Shell Mill Holder - Coolant Fed
Page 22	Shrink Fit Holder 4.5° - Inch Sizes
Page 23	Shrink Fit Holder 4.5° - Metric Sizes
Page 24	Wrenches

## ER COLLET CHUCK - STANDARD NUT

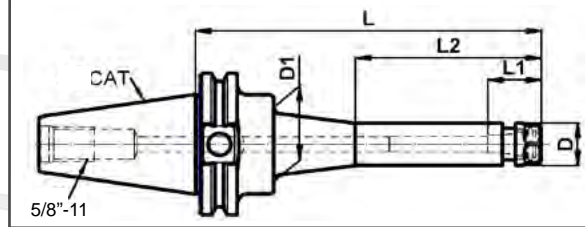

Order #	DIN Form B Order #	Description	Collet	Length	Range	D	D1	L	L1	L2
T00CA40020-11063A	T00CA40020-11063B	CAT40 ER11-2.5"	ER11	2.50"	1/16~1/4"	0.75"	0.75"	2.50"	0.66"	0.91"
T00CA40020-11089A	T00CA40020-11089B	CAT40 ER11-3.5"	ER11	3.50"	1/16~1/4"	0.75"	0.75"	3.50"	0.66"	1.91"
T00CA40020-11102A	T00CA40020-11102B	CAT40 ER11-4"	ER11	4.00"	1/16~1/4"	0.75"	0.75"	4.00"	0.66"	2.42"
T00CA40020-11152A	T00CA40020-11152B	CAT40 ER11-6"	ER11	6.00"	1/16~1/4"	0.75"	1.10"	6.00"	0.66"	3.30"
T00CA40020-11203A	T00CA40020-11203B	CAT40 ER11-8"	ER11	8.00"	1/16~1/4"	0.75"	1.10"	8.00"	0.66"	3.30"
T00CA40020-16063A	T00CA40020-16063B	CAT40 ER16-2.5"	ER16	2.50"	1/16~13/32"	1.10"	1.10"	2.50"	0.87"	0.91"
T00CA40020-16089A	T00CA40020-16089B	CAT40 ER16-3.5"	ER16	3.50"	1/16~13/32"	1.10"	1.10"	3.50"	0.87"	1.91"
T00CA40020-16102A	T00CA40020-16102B	CAT40 ER16-4"	ER16	4.00"	1/16~13/32"	1.10"	1.10"	4.00"	0.87"	2.42"
T00CA40020-16152A	T00CA40020-16152B	CAT40 ER16-6"	ER16	6.00"	1/16~13/32"	1.10"	1.10"	6.00"	0.87"	4.62"
T00CA40020-16203A	T00CA40020-16203B	CAT40 ER16-8"	ER16	8.00"	1/16~13/32"	1.10"	1.77"	8.00"	0.87"	3.34"
T00CA40020-16254A	T00CA40020-16254B	CAT40 ER16-10"	ER16	10.00"	1/16~13/32"	1.10"	1.77"	10.00"	0.87"	3.34"
T00CA40020-20063A	T00CA40020-20063B	CAT40 ER20-2.5"	ER20	2.50"	1/16~1/2"	1.34"	1.34"	2.50"	1.04"	0.91"
T00CA40020-20089A	T00CA40020-20089B	CAT40 ER20-3.5"	ER20	3.50"	1/16~1/2"	1.34"	1.34"	3.50"	1.04"	1.91"
T00CA40020-20102A	T00CA40020-20102B	CAT40 ER20-4"	ER20	4.00"	1/16~1/2"	1.34"	1.34"	4.00"	1.04"	2.42"
T00CA40020-20152A	T00CA40020-20152B	CAT40 ER20-6"	ER20	6.00"	1/16~1/2"	1.34"	1.34"	6.00"	1.04"	4.42"
T00CA40020-20203A	T00CA40020-20203B	CAT40 ER20-8"	ER20	8.00"	1/16~1/2"	1.34"	1.34"	8.00"	1.04"	6.42"
T00CA40020-20254A	T00CA40020-20254B	CAT40 ER20-10"	ER20	10.00"	1/16~1/2"	1.34"	1.34"	10.00"	1.04"	8.42"
T00CA40020-25063A	T00CA40020-25063B	CAT40 ER25-2.5"	ER25	2.50"	1/16~5/8"	1.65"	1.65"	2.50"	1.14"	0.91"
T00CA40020-25089A	T00CA40020-25089B	CAT40 ER25-3.5"	ER25	3.50"	1/16~5/8"	1.65"	1.65"	3.50"	1.14"	1.91"
T00CA40020-25102A	T00CA40020-25102B	CAT40 ER25-4"	ER25	4.00"	1/16~5/8"	1.65"	1.65"	4.00"	1.14"	2.42"
T00CA40020-25152A	T00CA40020-25152B	CAT40 ER25-6"	ER25	6.00"	1/16~5/8"	1.65"	1.65"	6.00"	1.14"	4.42"
T00CA40020-25203A	T00CA40020-25203B	CAT40 ER25-8"	ER25	8.00"	1/16~5/8"	1.65"	1.65"	8.00"	1.14"	6.42"
T00CA40020-25254A	T00CA40020-25254A	CAT40 ER25-10"	ER25	10.00"	1/16~5/8"	1.65"	1.65"	10.00"	1.14"	8.42"
T00CA40020-32070A	T00CA40020-32070A	CAT40 ER32-2.76"	ER32	2.76"	3/32~3/4"	1.97"	1.97"	2.76"	1.34"	1.17"
T00CA40020-32089A	T00CA40020-32089A	CAT40 ER32-3.5"	ER32	3.50"	3/32~3/4"	1.97"	1.97"	3.50"	1.34"	1.92"
T00CA40020-32102A	T00CA40020-32102A	CAT40 ER32-4"	ER32	4.00"	3/32~3/4"	1.97"	1.97"	4.00"	1.34"	2.42"
T00CA40020-32152A	T00CA40020-32152A	CAT40 ER32-6"	ER32	6.00"	3/32~3/4"	1.97"	1.97"	6.00"	1.34"	4.42"
T00CA40020-32203A	T00CA40020-32203A	CAT40 ER32-8"	ER32	8.00"	3/32~3/4"	1.97"	1.97"	8.00"	1.34"	6.42"
T00CA40020-32254A	T00CA40020-32254A	CAT40 ER32-10"	ER32	10.00"	3/32~3/4"	1.97"	1.97"	10.00"	1.34"	8.42"
T00CA40020-40120A	T00CA40020-40120A	CAT40 ER40-4.72"	ER40	4.72"	1/8~1"	2.48"	2.48"	4.72"	1.50"	3.14"
T00CA40020-40152A	T00CA40020-40152A	CAT40 ER40-6"	ER40	6.00"	1/8~1"	2.48"	2.48"	6.00"	1.50"	4.42"
T00CA40020-40203A	T00CA40020-40203A	CAT40 ER40-8"	ER40	8.00"	1/8~1"	2.48"	2.48"	8.00"	1.50"	6.42"

\*ER11, ER16 & ER20 have standard Hex Nut

\*ER25, ER32 & ER40 have Spanner Nut



## ER COLLET CHUCK - MINI NUT

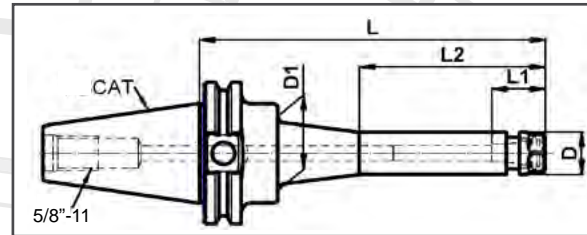

Order #	DIN Form B Order #	Description	Collet	Length	Range	D	D1	L	L1	L2
T00CA40M20-11063A	T00CA40M20-11063B	CAT40 ER11-2.5"M	ER11	2.5"	1/16~1/4"	0.63"	0.63"	2.5"	0.66"	0.91"
T00CA40M20-11102A	T00CA40M20-11102B	CAT40 ER11-4"M	ER11	4.0"	1/16~1/4"	0.63"	0.63"	4.0"	0.66"	2.42"
T00CA40M20-16063A	T00CA40M20-16063B	CAT40 ER16-2.5"M	ER16	2.5"	1/16~13/32"	0.87"	0.87"	2.5"	0.87"	0.91"
T00CA40M20-16102A	T00CA40M20-16102B	CAT40 ER16-4"M	ER16	4.0"	1/16~13/32"	0.87"	0.87"	4.0"	0.87"	2.42"
T00CA40M20-16152A	T00CA40M20-16152B	CAT40 ER16-6"M	ER16	6.0"	1/16~13/32"	0.87"	1.10"	6.0"	0.87"	3.30"
T00CA40M20-20063A	T00CA40M20-20063B	CAT40 ER20-2.5"M	ER20	2.5"	1/16~1/2"	1.10"	1.10"	2.5"	1.04"	0.91"
T00CA40M20-20102A	T00CA40M20-20102B	CAT40 ER20-4"M	ER20	4.0"	1/16~1/2"	1.10"	1.10"	4.0"	1.04"	2.42"
T00CA40M20-20152A	T00CA40M20-20152B	CAT40 ER20-6"M	ER20	6.0"	1/16~1/2"	1.10"	1.10"	6.0"	1.04"	4.42"

## SLIM COLLET CHUCK

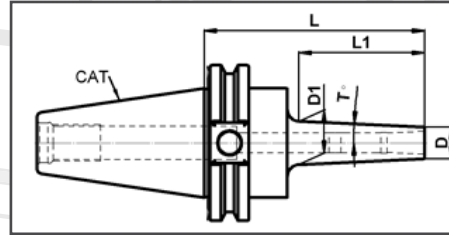

Order #	DIN Form B Order #	Description	Collet	Length	L	D	D1	T°	L1
T00CA40210-06102A	T00CA40210-06102B	CAT40 HC06-4"	HC06	4.00"	4.00"	0.51"	0.75"	2.5	2.82"
T00CA40210-06152A	T00CA40210-06152B	CAT40 HC06-6"	HC06	6.00"	6.00"	0.51"	0.94"	2.5	4.82"
T00CA40210-06203A	T00CA40210-06203B	CAT40 HC06-8"	HC06	8.00"	8.00"	0.51"	1.10"	2.5	6.82"
T00CA40210-10102A	T00CA40210-10102B	CAT40 HC10-4"	HC10	4.00"	4.00"	0.79"	1.10"	3.0	2.82"
T00CA40210-10152A	T00CA40210-10152B	CAT40 HC10-6"	HC10	6.00"	6.00"	0.79"	1.34"	3.0	4.82"
T00CA40210-10203A	T00CA40210-10203B	CAT40 HC10-8"	HC10	8.00"	8.00"	0.79"	1.50"	3.0	6.82"
T00CA40210-16102A	T00CA40210-16102B	CAT40 HC16-4"	HC16	4.00"	4.00"	1.26"	1.54"	3.0	2.82"
T00CA40210-16152A	T00CA40210-16152B	CAT40 HC16-6"	HC16	6.00"	6.00"	1.26"	1.77"	3.0	4.82"
T00CA40210-16203A	T00CA40210-16203B	CAT40 HC16-8"	HC16	8.00"	8.00"	1.26"	1.97"	3.0	6.82"

## HC COLLETS



### HC COLLETS (METRIC)

Order Number	Part Name	Collet	Shank
T03HC06-030	HC06 Collet 3mm	HC06	3
T03HC06-040	HC06 Collet 4mm	HC06	4
T03HC06-050	HC06 Collet 5mm	HC06	5
T03HC06-060	HC06 Collet 6mm	HC06	6
T03HC10-030	HC10 Collet 3mm	HC10	3
T03HC10-040	HC10 Collet 4mm	HC10	4
T03HC10-050	HC10 Collet 5mm	HC10	5
T03HC10-060	HC10 Collet 6mm	HC10	6
T03HC10-080	HC10 Collet 8mm	HC10	8
T03HC10-100	HC10 Collet 10mm	HC10	10
T03HC16-060	HC16 Collet 6mm	HC16	6
T03HC16-080	HC16 Collet 8mm	HC16	8
T03HC16-100	HC16 Collet 10mm	HC16	10
T03HC16-120	HC16 Collet 12mm	HC16	12
T03HC16-160	HC16 Collet 16mm	HC16	16

### HC COLLETS (INCH)

Order Number	Part Name	Collet	Shank
T03HC06A030	HC06 Collet 1/8"	HC06	1/8"
T03HC06A050	HC06 Collet 3/16"	HC06	3/16"
T03HC06A060	HC06 Collet 1/4"	HC06	1/4"
T03HC10A030	HC10 Collet 1/8"	HC10	1/8"
T03HC10A040	HC10 Collet 3/16"	HC10	3/16"
T03HC10A060	HC10 Collet 1/4"	HC10	1/4"
T03HC10A080	HC10 Collet 5/16"	HC10	5/16"
T03HC10A100	HC10 Collet 3/8"	HC10	3/8"
T03HC16A060	HC16 Collet 1/4"	HC16	1/4"
T03HC16A080	HC16 Collet 5/16"	HC16	5/16"
T03HC16A100	HC16 Collet 3/8"	HC16	3/8"
T03HC16A120	HC16 Collet 1/2"	HC16	1/2"
T03HC16A160	HC16 Collet 5/8"	HC16	5/8"

## SCREW IN HOLDER

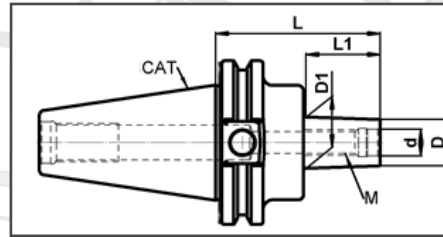

Order #	DIN Form B Order #	Description	M	L	D	D1	d	L1
T00CA40200-08040A	T00CA40200-08040B	CAT40 M08-1.58"	M08	1.58"	0.59"	0.59"	0.34"	0.2"
T00CA40200-08065A	T00CA40200-08065B	CAT40 M08-2.56"	M08	2.56"	0.59"	0.63"	0.34"	1.37"
T00CA40200-08087A	T00CA40200-08087B	CA40 M08-3.43"	M08	3.43"	0.51"	0.91"	0.34"	1.97"
T00CA40200-08102A	T00CA40200-08102B	CAT40 M08-4"	M08	4.00"	0.51"	0.91"	0.34"	1.97"
T00CA40200-08127A	T00CA40200-08127B	CAT40 M08-5"	M08	5.00"	0.51"	0.91"	0.34"	1.97"
T00CA40200-08152A	T00CA40200-08152B	CAT40 M08-6"	M08	6.00"	0.51"	0.91"	0.34"	1.97"
T00CA40200-10040A	T00CA40200-10040B	CAT40 M10-1.58"	M10	1.58"	0.71"	0.71"	0.41"	0.2"
T00CA40200-10065A	T00CA40200-10065B	CAT40 M10-2.56"	M10	2.56"	0.71"	0.78"	0.41"	1.37"
T00CA40200-10087A	T00CA40200-10087B	CAT40 M10-3.43"	M10	3.43"	0.71"	0.99"	0.41"	1.97"
T00CA40200-10102A	T00CA40200-10102B	CAT40 M10-4"	M10	4.00"	0.71"	0.99"	0.41"	2.56"
T00CA40200-10127A	T00CA40200-10127B	CAT40 M10-5"	M10	5.00"	0.71"	0.99"	0.41"	1.97"
T00CA40200-10152A	T00CA40200-10152B	CAT40 M10-6"	M10	6.00"	0.71"	0.99"	0.41"	1.97"
T00CA40200-12040A	T00CA40200-12040B	CAT40 M12-1.58"	M12	1.58"	0.83"	0.83"	0.49"	0.2"
T00CA40200-12065A	T00CA40200-12065B	CAT40 M12-2.56"	M12	2.56"	0.83"	0.90"	0.49"	1.37"
T00CA40200-12087A	T00CA40200-12087B	CAT40 M12-3.43"	M12	3.43"	0.83"	0.95"	0.49"	1.97"
T00CA40200-12102A	T00CA40200-12102B	CAT40 M12-4"	M12	4.00"	0.83"	0.95"	0.49"	2.56"
T00CA40200-12127A	T00CA40200-12127B	CAT40 M12-5"	M12	5.00"	0.83"	1.38"	0.49"	3.54"
T00CA40200-12152A	T00CA40200-12152B	CAT40 M12-6"	M12	6.00"	0.83"	1.38"	0.49"	3.54"
T00CA40200-12203A	T00CA40200-12203B	CAT40 M12-8"	M12	8.00"	0.83"	1.38"	0.49"	3.54"
T00CA40200-16040A	T00CA40200-16040B	CAT40 M16-1.58"	M16	1.58"	1.14"	1.14"	0.67"	0.2"
T00CA40200-16065A	T00CA40200-16065B	CAT40 M16-2.56"	M16	2.56"	1.14"	1.34"	0.67"	1.37"
T00CA40200-16087A	T00CA40200-16087B	CAT40 M16-3.43"	M16	3.43"	1.14"	1.34"	0.67"	1.97"
T00CA40200-16102A	T00CA40200-16102B	CAT40 M16-4"	M16	4.00"	1.14"	1.34"	0.67"	2.56"
T00CA40200-16127A	T00CA40200-16127B	CAT40 M16-5"	M16	5.00"	1.14"	1.54"	0.67"	3.54"
T00CA40200-16152A	T00CA40200-16152B	CAT40 M16-6"	M16	6.00"	1.14"	1.54"	0.67"	3.54"
T00CA40200-16203A	T00CA40200-16203B	CAT40 M16-8"	M16	8.00"	1.14"	1.54"	0.67"	3.54"

\* For use with ISO standard screw on heads.





## END MILL HOLDER INCH

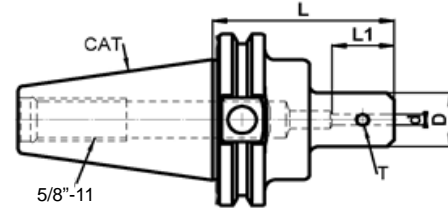

Order #	DIN Form B Order #	Description	d	D	L	L1	T
T00CA40040-03065A	T00CA40040-03065B	CAT40 EM1/8-2.56"	1/8"	0.69"	2.56"	0.63"	No.6-32
T00CA40040-03102A	T00CA40040-03102B	CAT40 EM1/8-4"	1/8"	0.69"	4.00"	0.63"	No.6-32
T00CA40040-05065A	T00CA40040-05065B	CAT40 EM3/16-2.56"	3/16"	0.79"	2.56"	0.86"	No.8-32
T00CA40040-05102A	T00CA40040-05102B	CAT40 EM3/16-4"	3/16"	0.79"	4.00"	0.86"	No.8-32
T00CA40040-06065A	T00CA40040-06065B	CAT40 EM1/4-2.56"	1/4"	0.79"	2.56"	1.18"	1/4"-28
T00CA40040-06102A	T00CA40040-06102B	CAT40 EM1/4-4"	1/4"	0.79"	4.00"	1.18"	1/4"-28
T00CA40040-06152A	T00CA40040-06152B	CAT40 EM1/4-6"	1/4"	0.79"	6.00"	1.18"	1/4"-28
T00CA40040-06203A	T00CA40040-06203B	CAT40 EM1/4-8"	1/4"	0.79"	8.00"	1.18"	1/4"-28
T00CA40040-08063A	T00CA40040-08063B	CAT40 EM5/16-2.5"	5/16"	1.00"	2.50"	1.37"	1/4"-28
T00CA40040-08102A	T00CA40040-08102B	CAT40 EM5/16-4"	5/16"	1.00"	4.00"	1.38"	1/4"-28
T00CA40040-08152A	T00CA40040-08152B	CAT40 EM5/16-6"	5/16"	1.00"	6.00"	1.38"	1/4"-28
T00CA40040-08203A	T00CA40040-08203B	CAT40 EM5/16-8"	5/16"	1.00"	8.00"	1.38"	1/4"-28
T00CA40040-09065A	T00CA40040-09065B	CAT40 EM3/8-2.56"	3/8"	1.00"	2.56"	1.54"	3/8"-24
T00CA40040-09102A	T00CA40040-09102B	CAT40 EM3/8-4"	3/8"	1.00"	4.00"	1.54"	3/8"-24
T00CA40040-09152A	T00CA40040-09152B	CAT40 EM3/8-6"	3/8"	1.00"	6.00"	1.54"	3/8"-24
T00CA40040-09203A	T00CA40040-09203B	CAT40 EM3/8-8"	3/8"	1.00"	8.00"	1.54"	3/8"-24
T00CA40040-12045A	T00CA40040-12045B	CAT40 EM1/2-1.75"	1/2"	1.38"	1.75"	1.73"	7/16"-20
T00CA40040-12065A	T00CA40040-12065B	CAT40 EM1/2-2.56"	1/2"	1.38"	2.56"	1.73"	7/16"-20
T00CA40040-12102A	T00CA40040-12102B	CAT40 EM1/2-4"	1/2"	1.38"	4.00"	1.73"	7/16"-20
T00CA40040-12152A	T00CA40040-12152B	CAT40 EM1/2-6"	1/2"	1.38"	6.00"	1.73"	7/16"-20
T00CA40040-12203A	T00CA40040-12203B	CAT40 EM1/2-8"	1/2"	1.38"	8.00"	1.73"	7/16"-20
T00CA40040-16045A	T00CA40040-16045B	CAT40 EM5/8-1.75"	5/8"	1.65"	1.75"	2.09"	9/16"-18
T00CA40040-16065A	T00CA40040-16065B	CAT40 EM5/8-2.56"	5/8"	1.65"	2.56"	2.09"	9/16"-18
T00CA40040-16102A	T00CA40040-16102B	CAT40 EM5/8-4"	5/8"	1.65"	4.00"	2.09"	9/16"-18
T00CA40040-16152A	T00CA40040-16152B	CAT40 EM5/8-6"	5/8"	1.65"	6.00"	2.09"	9/16"-18
T00CA40040-16203A	T00CA40040-16203B	CAT40 EM5/8-8"	5/8"	1.65"	8.00"	2.09"	9/16"-18
T00CA40040-19045A	T00CA40040-19045B	CAT40 EM3/4-1.75"	3/4"	1.75"	1.75"	2.17"	5/8"-18
T00CA40040-19065A	T00CA40040-19065B	CAT40 EM3/4-2.56"	3/4"	1.89"	2.56"	2.24"	5/8"-18
T00CA40040-19102A	T00CA40040-19102B	CAT40 EM3/4-4"	3/4"	1.89"	4.00"	2.24"	5/8"-18
T00CA40040-19152A	T00CA40040-19152B	CAT40 EM3/4-6"	3/4"	1.89"	6.00"	2.24"	5/8"-18
T00CA40040-19203A	T00CA40040-19203B	CAT40 EM3/4-8"	3/4"	1.89"	8.00"	2.24"	5/8"-18
T00CA40040-22045A	T00CA40040-22045B	CAT40 EM7/8-1.75"	7/8"	1.94"	1.75"	2.17"	5/8"-18
T00CA40040-22089A	T00CA40040-22089B	CAT40 EM7/8-3.5"	7/8"	2.00"	3.50"	2.17"	5/8"-18
T00CA40040-22152A	T00CA40040-22152B	CAT40 EM7/8-6"	7/8"	2.00"	6.00"	2.17"	5/8"-18
T00CA40040-22203A	T00CA40040-22203B	CAT40 EM7/8-8"	7/8"	2.00"	8.00"	2.17"	5/8"-18
T00CA40040-25050A	T00CA40040-25050B	CAT40 EM1-1.97"	1"	2.25"	1.97"	2.52"	3/4"-16
T00CA40040-25102A	T00CA40040-25102B	CAT40 EM1-4"	1"	2.36"	4.00"	2.36"	3/4"-16
T00CA40040-25152A	T00CA40040-25152B	CAT40 EM1-6"	1"	2.36"	6.00"	2.52"	3/4"-16
T00CA40040-25203A	T00CA40040-25203B	CAT40 EM1-8"	1"	2.36"	8.00"	2.52"	3/4"-16
T00CA40040-32102A	T00CA40040-32102B	CAT40 EM1 1/4-4"	1 1/4"	2.52"	4.00"	2.68"	3/4"-16
T00CA40040-32120A	T00CA40040-32120B	CAT40 EM1 1/4-4.72"	1 1/4"	2.52"	4.72"	2.68"	3/4"-16
T00CA40040-32152A	T00CA40040-32152B	CAT40 EM1 1/4-6"	1 1/4"	2.83"	6.00"	2.68"	3/4"-16
T00CA40040-32203A	T00CA40040-32203B	CAT40 EM1 1/4-8"	1 1/4"	2.83"	8.00"	2.68"	3/4"-16

## END MILL HOLDER INCH COOLANT SLOT

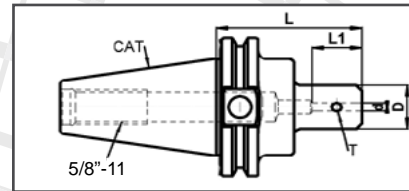

Order #	DIN Form B Order #	Description	d	D	L	L1	T
T00CA40030-03065A	T00CA40030-03065B	CAT40 EM 1/8"-2.56"J	1/8"	0.69"	2.56"	0.63"	No.6-32
T00CA40030-03102A	T00CA40030-03102B	CAT40 EM 1/8"-4"J	1/8"	0.69"	4.00"	0.63"	No.6-32
T00CA40030-05065A	T00CA40030-05065B	CAT40 EM 3/16"-2.56"J	3/16"	0.79"	2.56"	0.86"	No.8-32
T00CA40030-05102A	T00CA40030-05102B	CAT40 EM 3/16"-4"J	3/16"	0.79"	4.00"	0.86"	No.8-32
T00CA40030-06065A	T00CA40030-06065B	CAT40 EM 1/4"-2.56"J	1/4"	0.79"	2.56"	1.18"	1/4"-28
T00CA40030-06102A	T00CA40030-06102B	CAT40 EM 1/4"-4"J	1/4"	0.79"	4.00"	1.18"	1/4"-28
T00CA40030-06152A	T00CA40030-06152B	CAT40 EM 1/4"-6"J	1/4"	0.79"	6.00"	1.18"	1/4"-28
T00CA40030-08063A	T00CA40030-08063B	CAT40 EM 5/16"-2.5"J	5/16"	1.00"	2.50"	1.38"	1/4"-28
T00CA40030-08102A	T00CA40030-08102B	CAT40 EM 5/16"-4"J	5/16"	1.00"	4.00"	1.38"	1/4"-28
T00CA40030-08152A	T00CA40030-08152B	CABT40 EM 5/16"-6"J	5/16"	1.00"	6.00"	1.38"	1/4"-28
T00CA40030-09065A	T00CA40030-09065B	CAT40 EM 3/8"-2.56"J	3/8"	1.00"	2.56"	1.54"	3/8"-24
T00CA40030-09102A	T00CA40030-09102B	CAT40 EM 3/8"-4"J	3/8"	1.00"	4.00"	1.54"	3/8"-24
T00CA40030-09152A	T00CA40030-09152B	CAT40 EM 3/8"-6"J	3/8"	1.00"	6.00"	1.54"	3/8"-24
T00CA40030-12045A	T00CA40030-12045B	CAT40 EM 1/2"-1.75"J	1/2"	1.38"	1.75"	1.73"	7/16"-20
T00CA40030-12065A	T00CA40030-12065B	CAT40 EM 1/2"-2.56"J	1/2"	1.38"	2.56"	1.73"	7/16"-20
T00CA40030-12102A	T00CA40030-12102B	CAT40 EM 1/2"-4"J	1/2"	1.38"	4.00"	1.73"	7/16"-20
T00CA40030-12152A	T00CA40030-12152B	CAT40 EM 1/2"-6"J	1/2"	1.38"	6.00"	1.73"	7/16"-20
T00CA40030-16045A	T00CA40030-16045B	CAT40 EM 5/8"-1.75"J	5/8"	1.65"	1.75"	2.09"	9/16"-18
T00CA40030-16065A	T00CA40030-16065B	CAT40 EM 5/8"-2.56"J	5/8"	1.65"	2.56"	2.09"	9/16"-18
T00CA40030-16102A	T00CA40030-16102B	CAT40 EM 5/8"-4"J	5/8"	1.65"	4.00"	2.09"	9/16"-18
T00CA40030-16152A	T00CA40030-16152B	CAT40 EM 5/8"-6"J	5/8"	1.65"	6.00"	2.09"	9/16"-18
T00CA40030-19045A	T00CA40030-19045B	CAT40 EM 3/4"-1.75"J	3/4"	1.75"	1.75"	2.24"	5/8"-18
T00CA40030-19065A	T00CA40030-19065B	CAT40 EM 3/4"-2.56"J	3/4"	1.89"	2.56"	2.24"	5/8"-18
T00CA40030-19102A	T00CA40030-19102B	CAT40 EM 3/4"-4"J	3/4"	1.89"	4.00"	2.24"	5/8"-18
T00CA40030-19152A	T00CA40030-19152B	CAT40 EM 3/4"-6"J	3/4"	1.89"	6.00"	2.24"	5/8"-18
T00CA40030-22045A	T00CA40030-22045B	CAT40 EM 7/8"-1.75"J	7/8"	1.94"	1.75"	2.17"	5/8"-18
T00CA40030-22089A	T00CA40030-22089B	CAT40 EM 7/8"-3.5"J	7/8"	2.00"	3.50"	2.17"	5/8"-18
T00CA40030-22152A	T00CA40030-22152B	CAT40 EM 7/8"-6"J	7/8"	2.00"	6.00"	2.17"	5/8"-18
T00CA40030-25050A	T00CA40030-25050B	CAT40 EM 1"-1.97"J	1"	2.25"	1.97"	2.52"	3/4"-16
T00CA40030-25102A	T00CA40030-25102B	CAT40 EM 1"-4"J	1"	2.36"	4.00"	2.52"	3/4"-16
T00CA40030-25152A	T00CA40030-25152B	CAT40 EM 1"-6"J	1"	2.36"	6.00"	2.52"	3/4"-16
T00CA40030-32109A	T00CA40030-32109B	CAT40 EM 1 1/4"-4.29"J	1 1/4"	2.52"	4.29"	2.68"	3/4"-16
T00CA40030-32152A	T00CA40030-32152B	CAT40 EM 1 1/4"-6"J	1 1/4"	2.52"	6.00"	2.68"	3/4"-16
T00CA40030-32203A	T00CA40030-32203B	CAT40 EM 1 1/4"-8"J	1 1/4"	2.52"	8.00"	2.68"	3/4"-16

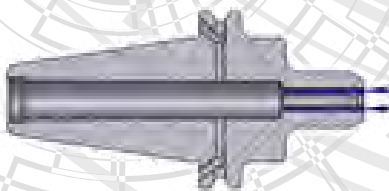

## SHELL MILL HOLDER INCH

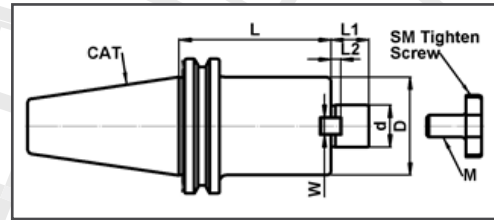

Order #	Description	d	L	D	L1	L2	W	M
T00CA40120-19035A	CAT40 SM 3/4"-1.38"	3/4"	1.38"	1.75"	0.68"	0.18"	5/16"	3/8"-24
T00CA40120-19070A	CAT40 SM 3/4"-2.75"	3/4"	2.75"	1.75"	0.68"	0.18"	5/16"	3/8"-24
T00CA40120-19102A	CAT40 SM 3/4"-4"	3/4"	4.00"	1.75"	0.68"	0.18"	5/16"	3/8"-24
T00CA40120-19152A	CAT40 SM 3/4"-6"	3/4"	6.00"	1.75"	0.68"	0.18"	5/16"	3/8"-24
T00CA40120-19203A	CAT40 SM 3/4"-8"	3/4"	8.00"	1.75"	0.68"	0.18"	5/16"	3/8"-24
T00CA40120-25051A	CAT40 SM 1"-2"	1"	2.00"	2.25"	0.68"	0.22"	3/8"	1/2"-20
T00CA40120-25102A	CAT40 SM 1"-4"	1"	4.00"	2.25"	0.68"	0.22"	3/8"	1/2"-20
T00CA40120-25152A	CAT40 SM 1"-6"	1"	6.00"	2.25"	0.68"	0.22"	3/8"	1/2"-20
T00CA40120-25203A	CAT40 SM 1"-8"	1"	8.00"	2.25"	0.68"	0.22"	3/8"	1/2"-20
T00CA40120-32051A	CAT40 SM 1 1/4"-2"	1 1/4"	2.00"	2.75"	0.68"	0.28"	1/2"	5/8"-18
T00CA40120-32102A	CAT40 SM 1 1/4"-4"	1 1/4"	4.00"	2.75"	0.68"	0.28"	1/2"	5/8"-18
T00CA40120-32152A	CAT40 SM 1 1/4"-6"	1 1/4"	6.00"	2.75"	0.68"	0.28"	1/2"	5/8"-18
T00CA40120-38061A	CAT40 SM 1 1/2"-2.4"	1 1/2"	2.00"	3.38"	0.94"	0.35"	5/8"	3/4"-16

## SHELL MILL HOLDER INCH

### COOLANT FED

DIN Form B Order #	Description	d	L	D	L1	L2	W	M
T00CA40130-19035B	CAT40 SM 3/4"-1.38"J	3/4"	1.38"	1.75"	0.68"	0.18"	5/16"	3/8"-24
T00CA40130-19070B	CAT40 SM 3/4"-2.75"J	3/4"	2.75"	1.75"	0.68"	0.18"	5/16"	3/8"-24
T00CA40130-19102B	CAT40 SM 3/4"-4"J	3/4"	4.00"	1.75"	0.68"	0.18"	5/16"	3/8"-24
T00CA40130-19152B	CAT40 SM 3/4"-6"J	3/4"	6.00"	1.75"	0.68"	0.18"	5/16"	3/8"-24
T00CA40130-19203B	CAT40 SM 3/4"-8"J	3/4"	8.00"	1.75"	0.68"	0.18"	5/16"	3/8"-24
T00CA40130-25051B	CAT40 SM 1"-2"J	1"	2.00"	2.25"	0.68"	0.22"	3/8"	1/2"-20
T00CA40130-25102B	CAT40 SM 1"-4"J	1"	4.00"	2.25"	0.68"	0.22"	3/8"	1/2"-20
T00CA40130-25152B	CAT40 SM 1"-6"J	1"	6.00"	2.25"	0.68"	0.22"	3/8"	1/2"-20
T00CA40130-25203B	CAT40 SM 1"-8"J	1"	8.00"	2.25"	0.68"	0.22"	3/8"	1/2"-20
T00CA40130-32051B	CAT40 SM 1 1/4"-2"J	1 1/4"	2.00"	2.75"	0.68"	0.28"	1/2"	5/8"-18
T00CA40130-32102B	CAT40 SM 1 1/4"-4"J	1 1/4"	4.00"	2.75"	0.68"	0.28"	1/2"	5/8"-18
T00CA40130-32152B	CAT40 SM 1 1/4"-6"J	1 1/4"	6.00"	2.75"	0.68"	0.28"	1/2"	5/8"-18
T00CA40130-38061B	CAT40 SM 1 1/2"-2.4"J	1 1/2"	2.00"	3.38"	0.94"	0.35"	5/8"	3/4"-16

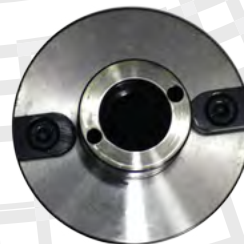
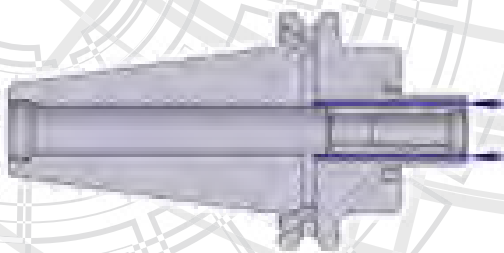

# CAT40 STANDARD TOOL HOLDERS



## SHRINK FIT HOLDER 4.5° INCH

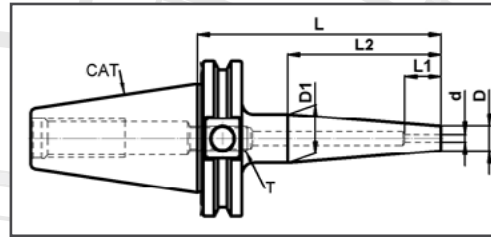

Order #	DIN Form B Order #	Description	L	d (shank)	L2	L1	D	D1	T	HSS
T00CA40220-03080A	T00CA40220-03080B	CAT40 SF1/8"-3.15"-4.5°	3.15"	1/8"	1.89"	0.59"	0.39"	0.71"	S10	YES
T00CA40220-05080A	T00CA40220-05080B	CAT40 SF3/16"-3.15"-4.5°	3.15"	3/16"	1.89"	0.79"	0.47"	0.79"	S10	YES
T00CA40220-06080A	T00CA40220-06080B	CAT40 SF1/4"-3.15"-4.5°	3.15"	1/4"	1.77"	1.14"	0.83"	1.11"	M5	YES
T00CA40220-08080A	T00CA40220-08080B	CAT40 SF5/16"-3.15"-4.5°	3.15"	5/16"	1.77"	0.87"	0.83"	1.11"	M6	YES
T00CA40220-09080A	T00CA40220-09080B	CAT40 SF3/8"-3.15"-4.5°	3.15"	3/8"	1.77"	1.22"	0.94"	1.22"	M8	YES
T00CA40220-12080A	T00CA40220-12080B	CAT40 SF1/2"-3.15"-4.5°	3.15"	1/2"	1.77"	1.42"	0.94"	1.22"	M10	YES
T00CA40220-16080A	T00CA40220-16080B	CAT40 SF5/8"-3.15"-4.5°	3.15"	5/8"	1.75"	1.54"	1.06"	1.34"	M12	YES
T00CA40220-19080A	T00CA40220-19080B	CAT40 SF3/4"-3.15"-4.5°	3.15"	3/4"	2.25"	1.61"	1.30"	1.65"	M16	YES
T00CA40220-22080A	T00CA40220-22080B	CAT40 SF7/8"-3.15"-4.5°	3.15"	7/8"	2.25"	1.61"	1.30"	1.65"	M16	YES
T00CA40220-22102A	T00CA40220-22102B	CAT40 SF7/8"-4"-4.5°	4.00"	7/8"	2.25"	1.61"	1.30"	1.65"	M16	YES
T00CA40220-25102A	T00CA40220-25102B	CAT40 SF1"-4"-4.5°	4.00"	1"	2.25"	1.85"	1.73"	2.09"	M16	YES
T00CA40220-32102A	T00CA40220-32102B	CAT40 SF1 1/4"-4"-4.5°	4.00"	1 1/4"	2.25"	1.85"	1.73"	2.09"	M16	YES



## SHRINK FIT HOLDER 4.5° METRIC

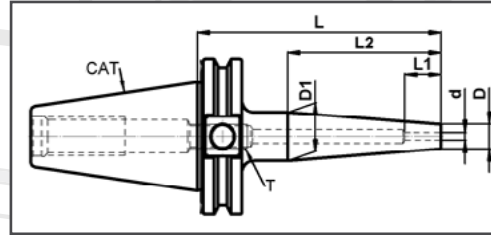

Order #	Order #	Description	L	d mm (shank)	L2	L1	D	D1	T	HSS
T00CA40220B03080A	T00CA40220B03080B	CAT40 SF03-3.15"-4.5°	3.15"	3	1.89"	0.59"	0.39"	0.71"	S10	YES
T00CA40220B04080A	T00CA40220B04080B	CAT40 SF04-3.15"-4.5°	3.15"	4	1.89"	0.63"	0.47"	0.79"	S10	YES
T00CA40220B05080A	T00CA40220B05080B	CAT40 SF05-3.15"-4.5°	3.15"	5	1.89"	0.79"	0.47"	0.79"	S10	YES
T00CA40220B06080A	T00CA40220B06080B	CAT40 SF06-3.15"-4.5°	3.15"	6	1.77"	1.14"	0.83"	1.11"	M5	YES
T00CA40220B08080A	T00CA40220B08080B	CAT40 SF08-3.15"-4.5°	3.15"	8	1.77"	0.87"	0.83"	1.11"	M6	YES
T00CA40220B10080A	T00CA40220B10080B	CAT40 SF10-3.15"-4.5°	3.15"	10	1.77"	1.22"	0.94"	1.22"	M8	YES
T00CA40220B12080A	T00CA40220B12080B	CAT40 SF12-3.15"-4.5°	3.15"	12	1.77"	1.42"	0.94"	1.22"	M10	YES
T00CA40220B16080A	T00CA40220B16080B	CAT40 SF16-3.15"-4.5°	3.15"	16	1.75"	1.54"	1.06"	1.34"	M12	YES
T00CA40220B20080A	T00CA40220B20080B	CAT40 SF20-3.15"-4.5°	3.15"	20	2.25"	1.61"	1.3"	1.65"	M16	YES
T00CA40220B20102A	T00CA40220B20102B	CAT40 SF20-4"-4.5°	4.00"	20	2.25"	1.61"	1.3"	1.65"	M16	YES
T00CA40220B25102A	T00CA40220B25102B	CAT40 SF25-4"-4.5°	4.00"	25	2.25"	1.85"	1.73"	2.09"	M16	YES
T00CA40220B32102A	T00CA40220B32102B	CAT40 SF32-4"-4.5°	4.00"	32	2.25"	1.85"	1.73"	2.09"	M16	YES

## ER COLLET CHUCK - STANDARD NUT

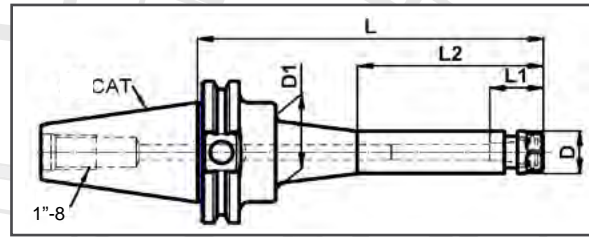

Order #	DIN Form B Order #	Description	Collet	Length	Range	D	D1	L	L1	L2
T00CA50020-16102A	T00CA50020-16102B	CAT50 ER16-4"	ER16	4.00"	1/16~13/32"	1.10"	1.10"	4.00"	0.87"	2.42"
T00CA50020-16152A	T00CA50020-16152B	CAT50 ER16-6"	ER16	6.00"	1/16~13/32"	1.10"	1.10"	6.00"	0.87"	4.62"
T00CA50020-16203A	T00CA50020-16203B	CAT50 ER16-8"	ER16	8.00"	1/16~13/32"	1.10"	1.77"	8.00"	0.87"	3.34"
T00CA50020-16254A	T00CA50020-16254B	CAT50 ER16-10"	ER16	10.00"	1/16~13/32"	1.10"	1.77"	10.00"	0.87"	3.34"
T00CA50020-16305A	T00CA50020-16305B	CAT50 ER16-12"	ER16	12.00"	1/16~13/32"	1.10"	1.77"	12.00"	0.87"	3.34"
T00CA50020-16381A	T00CA50020-16381B	CAT50 ER16-15"	ER16	15.00"	1/16~13/32"	1.10"	1.77"	15.00"	0.87"	3.34"
T00CA50020-20102A	T00CA50020-20102B	CAT50 ER20-4"	ER20	4.00"	1/16~1/2"	1.34"	1.34"	4.00"	1.04"	2.42"
T00CA50020-20152A	T00CA50020-20152B	CAT50 ER20-6"	ER20	6.00"	1/16~1/2"	1.34"	1.34"	6.00"	1.04"	4.42"
T00CA50020-20203A	T00CA50020-20203B	CAT50 ER20-8"	ER20	8.00"	1/16~1/2"	1.34"	1.34"	8.00"	1.04"	6.42"
T00CA50020-20254A	T00CA50020-20254B	CAT50 ER20-10"	ER20	10.00"	1/16~1/2"	1.34"	1.77"	10.00"	1.04"	3.34"
T00CA50020-20305A	T00CA50020-20305B	CAT50 ER20-12"	ER20	12.00"	1/16~1/2"	1.34"	1.77"	12.00"	1.04"	3.34"
T00CA50020-20381A	T00CA50020-20381B	CAT50 ER20-15"	ER20	15.00"	1/16~1/2"	1.34"	1.77"	15.00"	1.04"	3.34"
T00CA50020-25102A	T00CA50020-25102B	CAT50 ER25-4"	ER25	4.00"	1/16~5/8"	1.65"	1.65"	4.00"	1.14"	2.42"
T00CA50020-25152A	T00CA50020-25152B	CAT50 ER25-6"	ER25	6.00"	1/16~5/8"	1.65"	1.65"	6.00"	1.14"	4.42"
T00CA50020-25203A	T00CA50020-25203B	CAT50 ER25-8"	ER25	8.00"	1/16~5/8"	1.65"	1.65"	8.00"	1.14"	6.42"
T00CA50020-25254A	T00CA50020-25254B	CAT50 ER25-10"	ER25	10.00"	1/16~5/8"	1.65"	1.65"	10.00"	1.14"	8.42"
T00CA50020-25381A	T00CA50020-25381B	CAT50 ER25-15"	ER25	15.00"	1/16~5/8"	1.65"	2.75"	15.00"	1.14"	3.42"
T00CA50020-32070A	T00CA50020-32070B	CAT50 ER32-2.76"	ER32	2.76"	3/32~3/4"	1.97"	1.97"	2.76"	1.34"	1.18"
T00CA50020-32102A	T00CA50020-32102B	CAT50 ER32-4"	ER32	4.00"	3/32~3/4"	1.97"	1.97"	4.00"	1.34"	2.42"
T00CA50020-32152A	T00CA50020-32152B	CAT50 ER32-6"	ER32	6.00"	3/32~3/4"	1.97"	1.97"	6.00"	1.34"	4.42"
T00CA50020-32203A	T00CA50020-32203B	CAT50 ER32-8"	ER32	8.00"	3/32~3/4"	1.97"	1.97"	8.00"	1.34"	6.42"
T00CA50020-32254A	T00CA50020-32254B	CAT50 ER32-10"	ER32	10.00"	3/32~3/4"	1.97"	1.97"	10.00"	1.34"	8.42"
T00CA50020-32305A	T00CA50020-32305B	CAT50 ER32-12"	ER32	12.00"	3/32~3/4"	1.97"	1.97"	12.00"	1.34"	10.42"
T00CA50020-32381A	T00CA50020-32381B	CAT50 ER32-15"	ER32	15.00"	3/32~3/4"	1.97"	2.75"	15.00"	1.34"	3.46"
T00CA50020-40102A	T00CA50020-40102B	CAT50 ER40-4"	ER40	4.00"	1/8~1"	2.48"	2.48"	4.00"	1.50"	2.42"
T00CA50020-40120A	T00CA50020-40120B	CAT50 ER40-4.72"	ER40	4.72"	1/8~1"	2.48"	2.48"	4.72"	1.50"	3.14"
T00CA50020-40152A	T00CA50020-40152B	CAT50 ER40-6"	ER40	6.00"	1/8~1"	2.48"	2.48"	6.00"	1.50"	4.42"
T00CA50020-40203A	T00CA50020-40203B	CAT50 ER40-8"	ER40	8.00"	1/8~1"	2.48"	2.48"	8.00"	1.50"	6.42"

\*ER11, ER16 & ER20 have standard Hex Nut

\*ER25, ER32 & ER40 have Spanner Nut



## ER COLLET CHUCK - MINI NUT

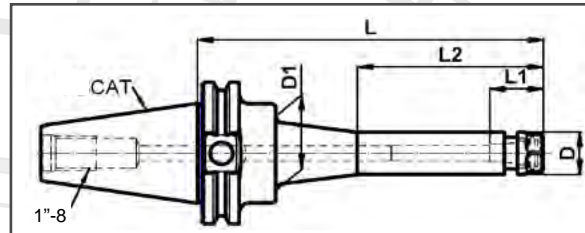

Order #	DIN Form B Order #	Description	Collet	Length	Range	D	D1	L	L1	L2
T00CA50M20-11102A	T00CA50M20-11102B	CAT50 ER11-4"M	ER11	4.0"	1/16~1/4"	0.63"	0.63"	4.00"	0.66"	2.42"
T00CA50M20-11152A	T00CA50M20-11152B	CAT50 ER11-6"M	ER11	6.0"	1/16~1/4"	0.63"	1.10"	6.00"	0.66"	2.95"
T00CA50M20-16102A	T00CA50M20-16102B	CAT50 ER16-4"M	ER16	4.0"	1/16~13/32"	0.63"	0.63"	4.00"	0.87"	2.44"
T00CA50M20-16152A	T00CA50M20-16152B	CAT50 ER16-6"M	ER16	6.0"	1/16~13/32"	0.87"	1.10"	6.00"	0.87"	3.30"
T00CA50M20-20102A	T00CA50M20-20102B	CAT50 ER20-4"M	ER20	4.0"	1/16~1/2"	1.10"	1.10"	4.00"	1.04"	2.44"
T00CA50M20-20152A	T00CA50M20-20152B	CAT50 ER20-6"M	ER20	6.0"	1/16~1/2"	1.10"	1.10"	6.00"	1.04"	3.30"

## SLIM COLLET CHUCK INCH

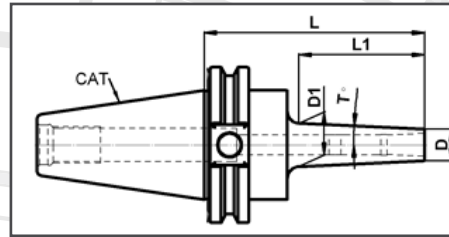

Order #	DIN Form B Order #	Description	Collet	Length	L	D	D1	T°	L1
T00CA50210-06102A	T00CA50210-06102B	CAT50 HC06-4"	HC06	4.00"	4.00"	0.51"	0.75"	2.5	2.82"
T00CA50210-06152A	T00CA50210-06152B	CAT50 HC06-6"	HC06	6.00"	6.00"	0.51"	0.94"	2.5	4.82"
T00CA50210-06203A	T00CA50210-06203B	CAT50 HC06-8"	HC06	8.00"	8.00"	0.51"	1.10"	2.5	6.82"
T00CA50210-10102A	T00CA50210-10102B	CAT50 HC10-4"	HC10	4.00"	4.00"	0.79"	1.10"	3.0	2.82"
T00CA50210-10152A	T00CA50210-10152B	CAT50 HC10-6"	HC10	6.00"	6.00"	0.79"	1.34"	3.0	4.82"
T00CA50210-10203A	T00CA50210-10203B	CAT50 HC10-8"	HC10	8.00"	8.00"	0.79"	1.50"	3.0	6.82"
T00CA50210-16102A	T00CA50210-16102B	CAT50 HC16-4"	HC16	4.00"	4.00"	1.26"	1.54"	3.0	2.82"
T00CA50210-16152A	T00CA50210-16152B	CAT50 HC16-6"	HC16	6.00"	6.00"	1.26"	1.77"	3.0	4.82"
T00CA50210-16203A	T00CA50210-16203B	CAT50 HC16-8"	HC16	8.00"	8.00"	1.26"	1.97"	3.0	6.82"

## HC COLLETS



### HC COLLETS (METRIC)

Order Number	Part Name	Collet	Shank
T03HC06-030	HC06 Collet 3mm	HC06	3
T03HC06-040	HC06 Collet 4mm	HC06	4
T03HC06-050	HC06 Collet 5mm	HC06	5
T03HC06-060	HC06 Collet 6mm	HC06	6
T03HC10-030	HC10 Collet 3mm	HC10	3
T03HC10-040	HC10 Collet 4mm	HC10	4
T03HC10-050	HC10 Collet 5mm	HC10	5
T03HC10-060	HC10 Collet 6mm	HC10	6
T03HC10-080	HC10 Collet 8mm	HC10	8
T03HC10-100	HC10 Collet 10mm	HC10	10
T03HC16-060	HC16 Collet 6mm	HC16	6
T03HC16-080	HC16 Collet 8mm	HC16	8
T03HC16-100	HC16 Collet 10mm	HC16	10
T03HC16-120	HC16 Collet 12mm	HC16	12
T03HC16-160	HC16 Collet 16mm	HC16	16

### HC COLLETS (INCH)

Order Number	Part Name	Collet	Shank
T03HC06A030	HC06 Collet 1/8"	HC06	1/8"
T03HC06A050	HC06 Collet 3/16"	HC06	3/16"
T03HC06A060	HC06 Collet 1/4"	HC06	1/4"
T03HC10A030	HC10 Collet 1/8"	HC10	1/8"
T03HC10A040	HC10 Collet 3/16"	HC10	3/16"
T03HC10A060	HC10 Collet 1/4"	HC10	1/4"
T03HC10A080	HC10 Collet 5/16"	HC10	5/16"
T03HC10A100	HC10 Collet 3/8"	HC10	3/8"
T03HC16A060	HC16 Collet 1/4"	HC16	1/4"
T03HC16A080	HC16 Collet 5/16"	HC16	5/16"
T03HC16A100	HC16 Collet 3/8"	HC16	3/8"
T03HC16A120	HC16 Collet 1/2"	HC16	1/2"
T03HC16A160	HC16 Collet 5/8"	HC16	5/8"



## SCREW IN HOLDER

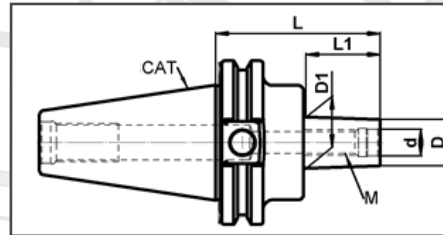

Order #	DIN Form B Order #	Description	M	L	D	D1	d	L1
T00CA50200-08087A	T00CA50200-08087B	CAT50 M08-3.43"	M08	3.43"	0.51"	0.91"	0.49"	1.37"
T00CA50200-08102A	T00CA50200-08102B	CAT50 M08-4"	M08	4.00"	0.51"	0.91"	0.49"	1.97"
T00CA50200-08127A	T00CA50200-08127B	CAT50 M08-5"	M08	5.00"	0.51"	0.91"	0.49"	1.97"
T00CA50200-10087A	T00CA50200-10087B	CAT50 M10-3.43"	M10	3.43"	0.71"	0.99"	0.49"	1.37"
T00CA50200-10102A	T00CA50200-10102B	CAT50 M10-4"	M10	4.00"	0.71"	0.99"	0.49"	1.97"
T00CA50200-10127A	T00CA50200-10127B	CAT50 M10-5"	M10	5.00"	0.71"	0.99"	0.49"	1.97"
T00CA50200-12102A	T00CA50200-12102B	CAT50 M12-4"	M12	4.00"	0.83"	0.95"	0.49"	1.97"
T00CA50200-12127A	T00CA50200-12127B	CAT50 M12-5"	M12	5.00"	0.83"	1.38"	0.49"	3.54"
T00CA50200-12152A	T00CA50200-12152B	CAT50 M12-6"	M12	6.00"	0.83"	1.38"	0.49"	3.54"
T00CA50200-12203A	T00CA50200-12203B	CAT50 M12-8"	M12	8.00"	0.83"	1.38"	0.49"	3.54"
T00CA50200-16102A	T00CA50200-16102B	CAT50 M16-4"	M16	4.00"	1.14"	1.34"	0.67"	1.97"
T00CA50200-16127A	T00CA50200-16127B	CAT50 M16-5"	M16	5.00"	1.14"	1.54"	0.67"	3.54"
T00CA50200-16152A	T00CA50200-16152B	CAT50 M16-6"	M16	6.00"	1.14"	1.54"	0.67"	3.54"
T00CA50200-16200A	T00CA50200-16200B	CAT50 M16-8"	M16	8.00"	1.14"	1.54"	0.67"	3.54"

\* For use with ISO standard screw on heads.

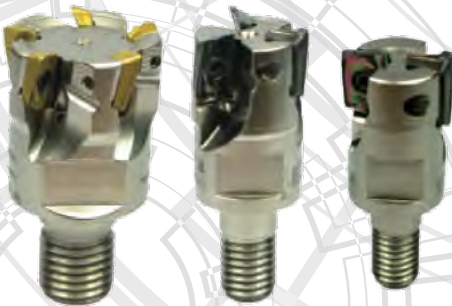

## END MILL HOLDER INCH

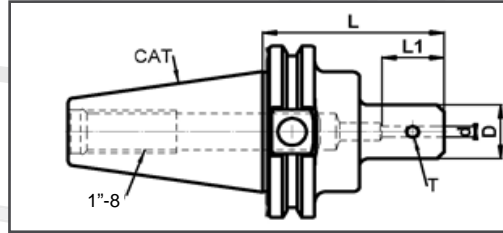

Order #	DIN Form B Order #	Description	d	D	L	L1	T
T00CA50040-06065A	T00CA50040-06065B	CAT50 EM1/4-2.56"	1/4"	0.79"	2.56"	1.18"	1/4"-28
T00CA50040-06102A	T00CA50040-06102B	CAT50 EM1/4-4"	1/4"	0.79"	4.00"	1.18"	1/4"-28
T00CA50040-06152A	T00CA50040-06152B	CAT50 EM1/4-6"	1/4"	0.79"	6.00"	1.18"	1/4"-28
T00CA50040-06203A	T00CA50040-06203B	CAT50 EM1/4-8"	1/4"	0.79"	8.00"	1.18"	1/4"-28
T00CA50040-08065A	T00CA50040-08065B	CAT50 EM5/16-2.56"	5/16"	1.00"	2.56"	1.38"	1/4"-28
T00CA50040-08102A	T00CA50040-08102B	CAT50 EM5/16-4"	5/16"	1.00"	4.00"	1.38"	1/4"-28
T00CA50040-08152A	T00CA50040-08152B	CAT50 EM5/16-6"	5/16"	1.00"	6.00"	1.38"	1/4"-28
T00CA50040-08203A	T00CA50040-08203B	CAT50 EM5/16-8"	5/16"	1.00"	8.00"	1.38"	1/4"-28
T00CA50040-09065A	T00CA50040-09065B	CAT50 EM3/8-2.56"	3/8"	1.00"	2.56"	1.54"	3/8"-24
T00CA50040-09102A	T00CA50040-09102B	CAT50 EM3/8-4"	3/8"	1.00"	4.00"	1.54"	3/8"-24
T00CA50040-09152A	T00CA50040-09152B	CAT50 EM3/8-6"	3/8"	1.00"	6.00"	1.54"	3/8"-24
T00CA50040-09203A	T00CA50040-09203B	CAT50 EM3/8-8"	3/8"	1.00"	8.00"	1.54"	3/8"-24
T00CA50040-12075A	T00CA50040-12075B	CAT50 EM1/2-2.95"	1/2"	1.38"	2.95"	1.73"	7/16"-20
T00CA50040-12102A	T00CA50040-12102B	CAT50 EM1/2-4"	1/2"	1.38"	4.00"	1.73"	7/16"-20
T00CA50040-12152A	T00CA50040-12152B	CAT50 EM1/2"-6"	1/2"	1.38"	6.00"	1.73"	7/16"-20
T00CA50040-12203A	T00CA50040-12203B	CAT50 EM1/2"-8"	1/2"	1.38"	8.00"	1.73"	7/16"-20
T00CA50040-16076A	T00CA50040-16076B	CAT50 EM5/8"-3"	5/8"	1.65"	3.00"	2.09"	9/16"-18
T00CA50040-16102A	T00CA50040-16102B	CAT50 EM5/8"-4"	5/8"	1.65"	4.00"	2.09"	9/16"-18
T00CA50040-16152A	T00CA50040-16152B	CAT50 EM5/8"-6"	5/8"	1.65"	6.00"	2.09"	9/16"-18
T00CA50040-16203A	T00CA50040-16203B	CAT50 EM5/8"-8"	5/8"	1.65"	8.00"	2.09"	9/16"-18
T00CA50040-19076A	T00CA50040-19076B	CAT50 EM3/4"-3"	3/4"	1.89"	3.00"	2.24"	5/8"-18
T00CA50040-19102A	T00CA50040-19102B	CAT50 EM3/4"-4"	3/4"	1.89"	4.00"	2.24"	5/8"-18
T00CA50040-19152A	T00CA50040-19152B	CAT50 EM3/4"-6"	3/4"	1.89"	6.00"	2.24"	5/8"-18
T00CA50040-19203A	T00CA50040-19203B	CAT50 EM3/4"-8"	3/4"	1.89"	8.00"	2.24"	5/8"-18
T00CA50040-22089A	T00CA50040-22089B	CAT50 EM7/8"-3.5"	7/8"	2.00"	3.5"	2.17"	5/8"-18
T00CA50040-22152A	T00CA50040-22152B	CAT50 EM7/8"-6"	7/8"	2.00"	6.00"	2.17"	5/8"-18
T00CA50040-22203A	T00CA50040-22203B	CAT50 EM7/8"-8"	7/8"	2.00"	8.00"	2.17"	5/8"-18
T00CA50040-25102A	T00CA50040-25102B	CAT50 EM1"-4"	1"	2.25"	4.00"	2.52"	3/4"-16
T00CA50040-25152A	T00CA50040-25152B	CAT50 EM1"-6"	1"	2.36"	6.00"	2.52"	3/4"-16
T00CA50040-25203A	T00CA50040-25203B	CAT50 EM1"-8"	1"	2.36"	8.00"	2.52"	3/4"-16
T00CA50040-32102A	T00CA50040-32102B	CAT50 EM1 1/4"-4"	1 1/4"	2.52"	4.00"	2.68"	3/4"-16
T00CA50040-32152A	T00CA50040-32152B	CAT50 EM1 1/4"-6"	1 1/4"	2.83"	6.00"	2.68"	3/4"-16
T00CA50040-32203A	T00CA50040-32203B	CAT50 EM1 1/4"-8"	1 1/4"	2.83"	8.00"	2.68"	3/4"-16
T00CA50040-38102A	T00CA50040-38102B	CAT50 EM1 1/2"-4"	1 1/2"	2.75"	4.00"	2.38"	3/4"-16
T00CA50040-38152A	T00CA50040-38152B	CAT50 EM1 1/2"-6"	1 1/2"	2.75"	6.00"	2.38"	3/4"-16
T00CA50040-38203A	T00CA50040-38203B	CAT50 EM1 1/2"-8"	1 1/2"	2.75"	8.00"	2.38"	3/4"-16
T00CA50040-50152A	T00CA50040-50152B	CAT50 EM2"-6"	2"	3.75"	6.00"	3.38"	1"-14
T00CA50040-50203A	T00CA50040-50203B	CAT50 EM2"-8"	2"	3.75"	8.00"	3.38"	1"-14

## END MILL HOLDER INCH COOLANT SLOT

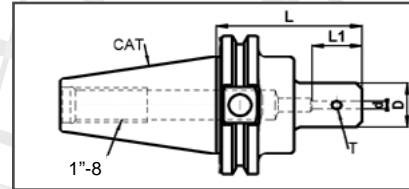

Order #	DIN Form B Order #	Description	d	D	L	L1	T
T00CA50030-06065A	T00CA50030-06065B	CAT50 EM 1/4"-2.56"J	1/4"	0.79"	2.56"	1.18"	1/4"-28
T00CA50030-06102A	T00CA50030-06102B	CAT50 EM 1/4"-4"J	1/4"	0.79"	4.00"	1.18"	1/4"-28
T00CA50030-06152A	T00CA50030-06152B	CAT50 EM 1/4"-6"J	1/4"	0.79"	6.00"	1.18"	1/4"-28
T00CA50030-06203A	T00CA50030-06203B	CAT50 EM 1/4"-8"J	1/4"	0.79"	8.00"	1.18"	1/4"-28
T00CA50030-08065A	T00CA50030-08065B	CAT50 EM 5/16"-2.56"J	5/16"	1.00"	2.56"	1.38"	1/4"-28
T00CA50030-08102A	T00CA50030-08102B	CAT50 EM 5/16"-4"J	5/16"	1.00"	4.00"	1.38"	1/4"-28
T00CA50030-08152A	T00CA50030-08152B	CAT50 EM 5/16"-6"J	5/16"	1.00"	6.00"	1.38"	1/4"-28
T00CA50030-08203A	T00CA50030-08203B	CAT50 EM 5/16"-8"J	5/16"	1.00"	8.00"	1.38"	1/4"-28
T00CA50030-09065A	T00CA50030-09065B	CAT50 EM 3/8"-2.56"J	3/8"	1.00"	2.56"	1.54"	3/8"-24
T00CA50030-09102A	T00CA50030-09102B	CAT50 EM 3/8"-4"J	3/8"	1.00"	4.00"	1.54"	3/8"-24
T00CA50030-09152A	T00CA50030-09152B	CAT50 EM 3/8"-6"J	3/8"	1.00"	6.00"	1.54"	3/8"-24
T00CA50030-09203A	T00CA50030-09203B	CAT50 EM 3/8"-8"J	3/8"	1.00"	8.00"	1.54"	3/8"-24
T00CA50030-12075A	T00CA50030-12075B	CAT50 EM 1/2"-2.95"J	1/2"	1.38"	2.95"	1.73"	7/16"-20
T00CA50030-12102A	T00CA50030-12102B	CAT50 EM 1/2"-4"J	1/2"	1.38"	4.00"	1.73"	7/16"-20
T00CA50030-12152A	T00CA50030-12152B	CAT50 EM 1/2"-6"J	1/2"	1.38"	6.00"	1.73"	7/16"-20
T00CA50030-12203A	T00CA50030-12203B	CAT50 EM 1/2"-8"J	1/2"	1.38"	8.00"	1.73"	7/16"-20
T00CA50030-16076A	T00CA50030-16076B	CAT50 EM 5/8"-3"J	5/8"	1.65"	3.00"	2.09"	9/16"-18
T00CA50030-16102A	T00CA50030-16102B	CAT50 EM 5/8"-4"J	5/8"	1.65"	4.00"	2.09"	9/16"-18
T00CA50030-16152A	T00CA50030-16152B	CAT50 EM 5/8"-6"J	5/8"	1.65"	6.00"	2.09"	9/16"-18
T00CA50030-16203A	T00CA50030-16203B	CAT50 EM 5/8"-8"J	5/8"	1.65"	8.00"	2.09"	9/16"-18
T00CA50030-19076A	T00CA50030-19076B	CAT50 EM 3/4"-3"J	3/4"	1.89"	3.00"	2.24"	5/8"-18
T00CA50030-19102A	T00CA50030-19102B	CAT50 EM 3/4"-4"J	3/4"	1.89"	4.00"	2.24"	5/8"-18
T00CA50030-19152A	T00CA50030-19152B	CAT50 EM 3/4"-6"J	3/4"	1.89"	6.00"	2.24"	5/8"-18
T00CA50030-19203A	T00CA50030-19203B	CAT50 EM 3/4"-8"J	3/4"	1.89"	8.00"	2.24"	5/8"-18
T00CA50030-22089A	T00CA50030-22089B	CAT50 EM 7/8"-3.5"J	7/8"	2.00"	3.50"	2.17"	5/8"-18
T00CA50030-22152A	T00CA50030-22152B	CAT50 EM 7/8"-6"J	7/8"	2.00"	6.00"	2.17"	5/8"-18
T00CA50030-22203A	T00CA50030-22203B	CAT50 EM 7/8"-8"J	7/8"	2.00"	8.00"	2.17"	5/8"-18
T00CA50030-25102A	T00CA50030-25102B	CAT50 EM 1"-4"J	1"	2.25"	4.00"	2.52"	3/4"-16
T00CA50030-25152A	T00CA50030-25152B	CAT50 EM 1"-6"J	1"	2.36"	6.00"	2.52"	3/4"-16
T00CA50030-25203A	T00CA50030-25203B	CAT50 EM 1"-8"J	1"	2.36"	8.00"	2.52"	3/4"-16
T00CA50030-32102A	T00CA50030-32102B	CAT50 EM 1 1/4"-4"J	1 1/4"	2.48"	4.00"	2.68"	3/4"-16
T00CA50030-32152A	T00CA50030-32152B	CAT50 EM 1 1/4"-6"J	1 1/4"	2.48"	6.00"	2.68"	3/4"-16
T00CA50030-32203A	T00CA50030-32203B	CAT50 EM 1 1/4"-8"J	1 1/4"	2.48"	8.00"	2.68"	3/4"-16

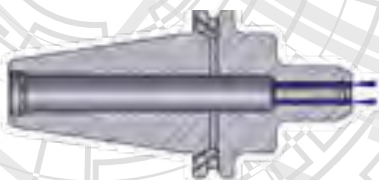

## SHELL MILL HOLDER INCH

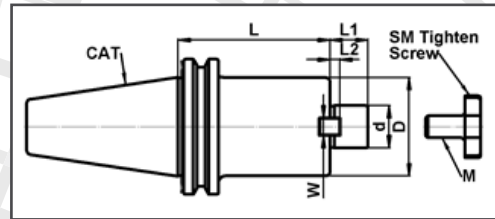

Order #	Description	d	L	D	L1	L2	W	M
T00CA50120-19051A	CAT50 SM 3/4"-2"	3/4"	2.00"	1.75"	0.68"	0.18"	5/16"	3/8"-24
T00CA50120-19102A	CAT50 SM 3/4"-4"	3/4"	4.00"	1.75"	0.68"	0.18"	5/16"	3/8"-24
T00CA50120-19152A	CAT50 SM 3/4"-6"	3/4"	6.00"	1.75"	0.68"	0.18"	5/16"	3/8"-24
T00CA50120-19203A	CAT50 SM 3/4"-8"	3/4"	8.00"	1.75"	0.68"	0.18"	5/16"	3/8"-24
T00CA50120-19051A01	CAT50 SMB 3/4"-2"	3/4"	2.00"	1.97"	0.68"	0.18"	5/16"	3/8"-24
T00CA50120-19102A01	CAT50 SMB 3/4"-4"	3/4"	4.00"	1.97"	0.68"	0.18"	5/16"	3/8"-24
T00CA50120-19152A01	CAT50 SMB 3/4"-6"	3/4"	6.00"	1.97"	0.68"	0.18"	5/16"	3/8"-24
T00CA50120-19203A01	CAT50 SMB 3/4"-8"	3/4"	8.00"	1.97"	0.68"	0.18"	5/16"	3/8"-24
T00CA50120-25051A	CAT50 SM 1"-2"	1"	2.00"	2.25"	0.68"	0.22"	3/8"	1/2"-20
T00CA50120-25102A	CAT50 SM 1"-4"	1"	4.00"	2.25"	0.68"	0.22"	3/8"	1/2"-20
T00CA50120-25152A	CAT50 SM 1"-6"	1"	6.00"	2.25"	0.68"	0.22"	3/8"	1/2"-20
T00CA50120-25203A	CAT50 SM 1"-8"	1"	8.00"	2.25"	0.68"	0.22"	3/8"	1/2"-20
T00CA50120-25051A01	CAT50 SMB 1"-2"	1"	2.00"	2.48"	0.68"	0.22"	3/8"	1/2"-20
T00CA50120-25102A01	CAT50 SMB 1"-4"	1"	4.00"	2.48"	0.68"	0.22"	3/8"	1/2"-20
T00CA50120-25152A01	CAT50 SMB 1"-6"	1"	6.00"	2.48"	0.68"	0.22"	3/8"	1/2"-20
T00CA50120-25203A01	CAT50 SMB 1"-8"	1"	8.00"	2.48"	0.68"	0.22"	3/8"	1/2"-20
T00CA50120-32051A	CAT50 SM 1 1/4"-2"	1 1/4"	2.00"	2.75"	0.68"	0.28"	1/2"	5/8"-18
T00CA50120-32102A	CAT50 SM 1 1/4"-4"	1 1/4"	4.00"	2.75"	0.68"	0.28"	1/2"	5/8"-18
T00CA50120-32152A	CAT50 SM 1 1/4"-6"	1 1/4"	6.00"	2.75"	0.68"	0.28"	1/2"	5/8"-18
T00CA50120-32203A	CAT50 SM 1 1/4"-8"	1 1/4"	8.00"	2.75"	0.68"	0.28"	1/2"	5/8"-18
T00CA50120-32051A01	CAT50 SMB 1 1/4"-2"	1 1/4"	2.00"	2.90"	0.68"	0.28"	1/2"	5/8"-18
T00CA50120-32102A01	CAT50 SMB 1 1/4"-4"	1 1/4"	4.00"	2.90"	0.68"	0.28"	1/2"	5/8"-18
T00CA50120-32152A01	CAT50 SMB 1 1/4"-6"	1 1/4"	6.00"	2.90"	0.68"	0.28"	1/2"	5/8"-18
T00CA50120-32203A01	CAT50 SMB 1 1/4"-8"	1 1/4"	8.00"	2.90"	0.68"	0.28"	1/2"	5/8"-18
T00CA50120-38061A	CAT50 SM 1 1/2"-2.4"	1 1/2"	2.40"	3.38"	0.94"	0.35"	5/8"	3/4"-16
T00CA50120-38102A	CAT50 SM 1 1/2"-4"	1 1/2"	4.00"	3.38"	0.94"	0.35"	5/8"	3/4"-16
T00CA50120-38061A01	CAT50 SMB 1 1/2"-2.4"	1 1/2"	2.40"	3.90"	0.94"	0.35"	5/8"	3/4"-16
T00CA50120-38102A01	CAT50 SMB 1 1/2"-4"	1 1/2"	4.00"	3.90"	0.94"	0.35"	5/8"	3/4"-16
T00CA50120-50061A	CAT50 SM 2"-2.4"	2"	2.40"	4.88"	0.94"	0.39"	3/4"	1"-14
T00CA50120-50102A	CAT50 SM 2"-4"	2"	4.00"	4.88"	0.94"	0.39"	3/4"	1"-14



## SHELL MILL HOLDER INCH COOLANT FED

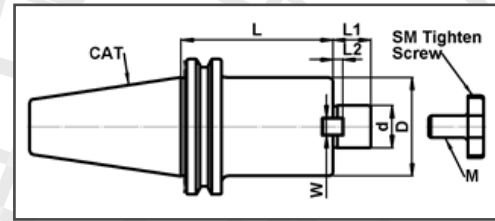

DIN Form B Order #	Description	d	L	D	L1	L2	W	M
T00CA50130-19051B	CAT50 SM 3/4"-2" J	3/4"	2.00"	1.75"	0.68"	0.18"	5/16"	3/8"-24
T00CA50130-19102B	CAT50 SM 3/4"-4" J	3/4"	4.00"	1.75"	0.68"	0.18"	5/16"	3/8"-24
T00CA50130-19152B	CAT50 SM 3/4"-6" J	3/4"	6.00"	1.75"	0.68"	0.18"	5/16"	3/8"-24
T00CA50130-19203B	CAT50 SM 3/4"-8" J	3/4"	8.00"	1.75"	0.68"	0.18"	5/16"	3/8"-24
T00CA50130-19051B01	CAT50 SMB 3/4"-2" J	3/4"	2.00"	1.97"	0.68"	0.18"	5/16"	3/8"-24
T00CA50130-19102B01	CAT50 SMB 3/4"-4" J	3/4"	4.00"	1.97"	0.68"	0.18"	5/16"	3/8"-24
T00CA50130-19152B01	CAT50 SMB 3/4"-6" J	3/4"	6.00"	1.97"	0.68"	0.18"	5/16"	3/8"-24
T00CA50130-19203B01	CAT50 SMB 3/4"-8" J	3/4"	8.00"	1.97"	0.68"	0.18"	5/16"	3/8"-24
T00CA50130-25051B	CAT50 SM 1"-2" J	1"	2.00"	2.25"	0.68"	0.22"	3/8"	1/2"-20
T00CA50130-25102B	CAT50 SM 1"-4" J	1"	4.00"	2.25"	0.68"	0.22"	3/8"	1/2"-20
T00CA50130-25152B	CAT50 SM 1"-6" J	1"	6.00"	2.25"	0.68"	0.22"	3/8"	1/2"-20
T00CA50130-25203B	CAT50 SM 1"-8" J	1"	8.00"	2.25"	0.68"	0.22"	3/8"	1/2"-20
T00CA50130-25051B01	CAT50 SMB 1"-2" J	1"	2.00"	2.48"	0.68"	0.22"	3/8"	1/2"-20
T00CA50130-25102B01	CAT50 SMB 1"-4" J	1"	4.00"	2.48"	0.68"	0.22"	3/8"	1/2"-20
T00CA50130-25152B01	CAT50 SMB 1"-6" J	1"	6.00"	2.48"	0.68"	0.22"	3/8"	1/2"-20
T00CA50130-25203B01	CAT50 SMB 1"-8" J	1"	8.00"	2.48"	0.68"	0.22"	3/8"	1/2"-20
T00CA50130-32051B	CAT50 SM 1 1/4"-2" J	1 1/4"	2.00"	2.75"	0.68"	0.28"	1/2"	5/8"-18
T00CA50130-32102B	CAT50 SM 1 1/4"-4" J	1 1/4"	4.00"	2.75"	0.68"	0.28"	1/2"	5/8"-18
T00CA50130-32152B	CAT50 SM 1 1/4"-6" J	1 1/4"	6.00"	2.75"	0.68"	0.28"	1/2"	5/8"-18
T00CA50130-32203B	CAT50 SM 1 1/4"-8" J	1 1/4"	8.00"	2.75"	0.68"	0.28"	1/2"	5/8"-18
T00CA50130-32051B01	CAT50 SMB 1 1/4"-2" J	1 1/4"	2.00"	2.90"	0.68"	0.28"	1/2"	5/8"-18
T00CA50130-32102B01	CAT50 SMB 1 1/4"-4" J	1 1/4"	4.00"	2.90"	0.68"	0.28"	1/2"	5/8"-18
T00CA50130-32152B01	CAT50 SMB 1 1/4"-6" J	1 1/4"	6.00"	2.90"	0.68"	0.28"	1/2"	5/8"-18
T00CA50130-32203B01	CAT50 SMB 1 1/4"-8" J	1 1/4"	8.00"	2.90"	0.68"	0.28"	1/2"	5/8"-18
T00CA50130-38061B	CAT50 SM 1 1/2"-2.4" J	1 1/2"	2.40"	3.38"	0.94"	0.35"	5/8"	3/4"-16
T00CA50130-38102B	CAT50 SM 1 1/2"-4" J	1 1/2"	4.00"	3.38"	0.94"	0.35"	5/8"	3/4"-16
T00CA50130-38061B01	CAT50 SMB 1 1/2"-2.4" J	1 1/2"	2.40"	3.90"	0.94"	0.35"	5/8"	3/4"-16
T00CA50130-38102B01	CAT50 SMB 1 1/2"-4" J	1 1/2"	4.00"	3.90"	0.94"	0.35"	5/8"	3/4"-16
T00CA50130-50061B	CAT50 SM 2"-2.4" J	2"	2.40"	4.88"	0.94"	0.39"	3/4"	1"-14
T00CA50130-50102B	CAT50 SM 2"-4" J	2"	4.00"	4.88"	0.94"	0.39"	3/4"	1"-14

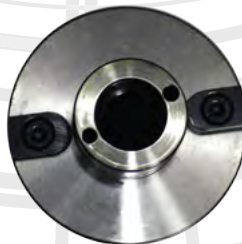
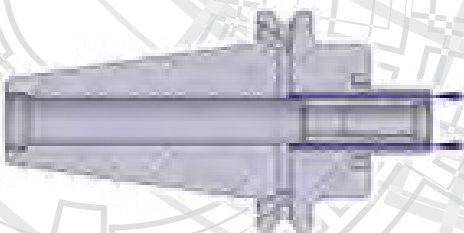

## SHRINK FIT HOLDER 4.5° INCH

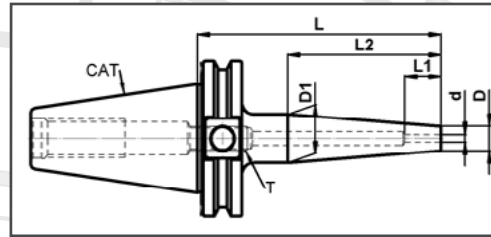

Order #	DIN Form B Order #	Description	L	d (shank)	L2	L1	D	D1	T	HSS
T00CA50220-03102A	T00CA50220-03102B	CAT50 SF1/8"-4"-4.5°	4.00"	1/8"	2.50"	0.59"	0.39"	0.79"	S10	YES
T00CA50220-05102A	T00CA50220-05102B	CAT50 SF3/16"-4"-4.5°	4.00"	3/16"	2.50"	0.79"	0.47"	0.87"	S10	YES
T00CA50220-06080A	T00CA50220-06080B	CAT50 SF1/4"-3.15"-4.5°	3.15"	1/4"	1.77"	1.14"	0.83"	1.11"	M5	YES
T00CA50220-08080A	T00CA50220-08080B	CAT50 SF5/16"-3.15"-4.5°	3.15"	5/16"	1.77"	0.87"	0.83"	1.11"	M6	YES
T00CA50220-09080A	T00CA50220-09080B	CAT50 SF3/8"-3.15"-4.5°	3.15"	3/8"	1.77"	1.22"	0.94"	1.22"	M8	YES
T00CA50220-12080A	T00CA50220-12080B	CAT50 SF1/2"-3.15"-4.5°	3.15"	1/2"	1.77"	1.42"	0.94"	1.22"	M10	YES
T00CA50220-16080A	T00CA50220-16080B	CAT50 SF5/8"-3.15"-4.5°	3.15"	5/8"	1.75"	1.54"	1.06"	1.34"	M12	YES
T00CA50220-19080A	T00CA50220-19080B	CAT50 SF3/4"-3.15"-4.5°	3.15"	3/4"	2.25"	1.61"	1.30"	1.65"	M16	YES
T00CA50220-25102A	T00CA50220-25102B	CAT50 SF1"-4.00"-4.5°	4.00"	1"	2.25"	1.85"	1.73"	2.09"	M16	YES
T00CA50220-32102A	T00CA50220-32102B	CAT50 SF1 1/4"-4.00"-4.5°	4.00"	1 1/4"	2.25"	1.85"	1.73"	2.09"	M16	YES

## SHRINK FIT HOLDER 4.5° METRIC

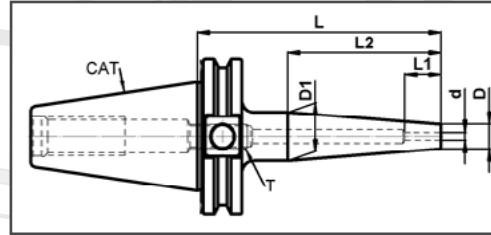

Order #	DIN Form B Order #	Description	L	d mm (shank)	L2	L1	D	D1	T	HSS
T00CA50220B03102A	T00CA50220B03102B	CAT50 SF03-4"-4.5°	4.00"	3	2.50"	0.59"	0.39"	0.79"	S10	YES
T00CA50220B04102A	T00CA50220B04102B	CAT50 SF04-4"-4.5°	4.00"	4	2.50"	0.63"	0.39"	0.87"	S10	YES
T00CA50220B05102A	T00CA50220B05102B	CAT50 SF05-4"-4.5°	4.00"	5	2.50"	0.79"	0.47"	0.87"	S10	YES
T00CA50220B06080A	T00CA50220B06080B	CAT50 SF06-3.15"-4.5°	3.15"	6	1.77"	1.14"	0.83"	1.11"	M5	YES
T00CA50220B08080A	T00CA50220B08080B	CAT50 SF08-3.15"-4.5°	3.15"	8	1.77"	0.87"	0.83"	1.11"	M6	YES
T00CA50220B10080A	T00CA50220B10080B	CAT50 SF10-3.15"-4.5°	3.15"	10	1.77"	1.22"	0.94"	1.22"	M8	YES
T00CA50220B12080A	T00CA50220B12080B	CAT50 SF12-3.15"-4.5°	3.15"	12	1.77"	1.42"	0.94"	1.22"	M10	YES
T00CA50220B16080A	T00CA50220B16080B	CAT50 SF16-3.15"-4.5°	3.15"	16	1.75"	1.54"	1.06"	1.34"	M12	YES
T00CA50220B20080A	T00CA50220B20080B	CAT50 SF20-3.15"-4.5°	3.15"	20	2.25"	1.61"	1.3"	1.65"	M16	YES
T00CA50220B25102A	T00CA50220B25102B	CAT50 SF25-4"-4.5°	4.00"	25	2.25"	1.85"	1.73"	2.09"	M16	YES
T00CA50220B32102A	T00CA50220B32102B	CAT50 SF32-4"-4.5°	4.00"	32	2.25"	1.85"	1.73"	2.09"	M16	YES

# Wrenches

## MINI NUT WRENCH

Order Number	Part Name	D	L	NUT
T07ER0805	ER08 MINI WRENCH	12	100	ER08M
T07ER1105	ER11 MINI WRENCH	16	100	ER11M
T07ER1605	ER16 MINI WRENCH	22	120	ER16M
T07ER2005	ER20 MINI WRENCH	28	120	ER20M

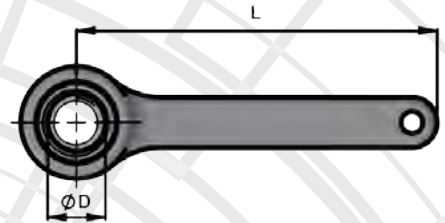

## HEX NUT WRENCH

Order Number	Part Name	D	L	NUT
T07IR0801	IR08 HEX WRENCH	11	165	-
T07IR8S01	IR8S HEX WRENCH	14	165	-
T07ER1101	ER11 HEX WRENCH	17	165	ER11 HEX
T07ER1601	ER16 HEX WRENCH	25	204	ER16 HEX
T07ER2001	ER20 HEX WRENCH	30	210	ER20 HEX

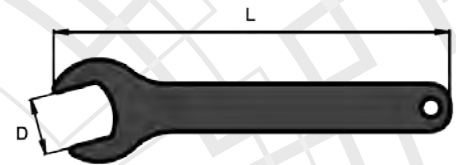

## ER NUT SPANNER WRENCH

Order Number	Part Name	D	L	NUT
T07ER2502	ER25 WRENCH	42	210	ER25
T07ER3202	ER32 WRENCH	50	250	ER32
T07ER4002	ER40 WRENCH	63	290	ER40

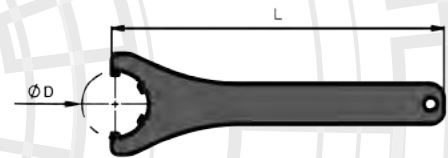





# ORDER INFORMATION

To order or receive more information about the PrimeTool I-System Tool Holders, contact your local On Target Tooling Distributor , call 262-502-4480 or email [sales@ontargettooling.com](mailto:sales@ontargettooling.com).

# ABOUT ON TARGET TOOLING, LLC

On Target Tooling, LLC is a company established as a Marketing company/Manufacturers Rep firm catering to companies specializing in the field of metal cutting. On Target Tooling has a team of highly technical and specialized Regional Technical Engineers that will provide unsurpassed value, technical support, and complete solutions to end users, distributors, and both machine tool builders and distributors alike.



On Target Tooling, LLC  
P.O. Box 1026  
Menomonee Falls, WI 53052  
(p) 262-502-4480

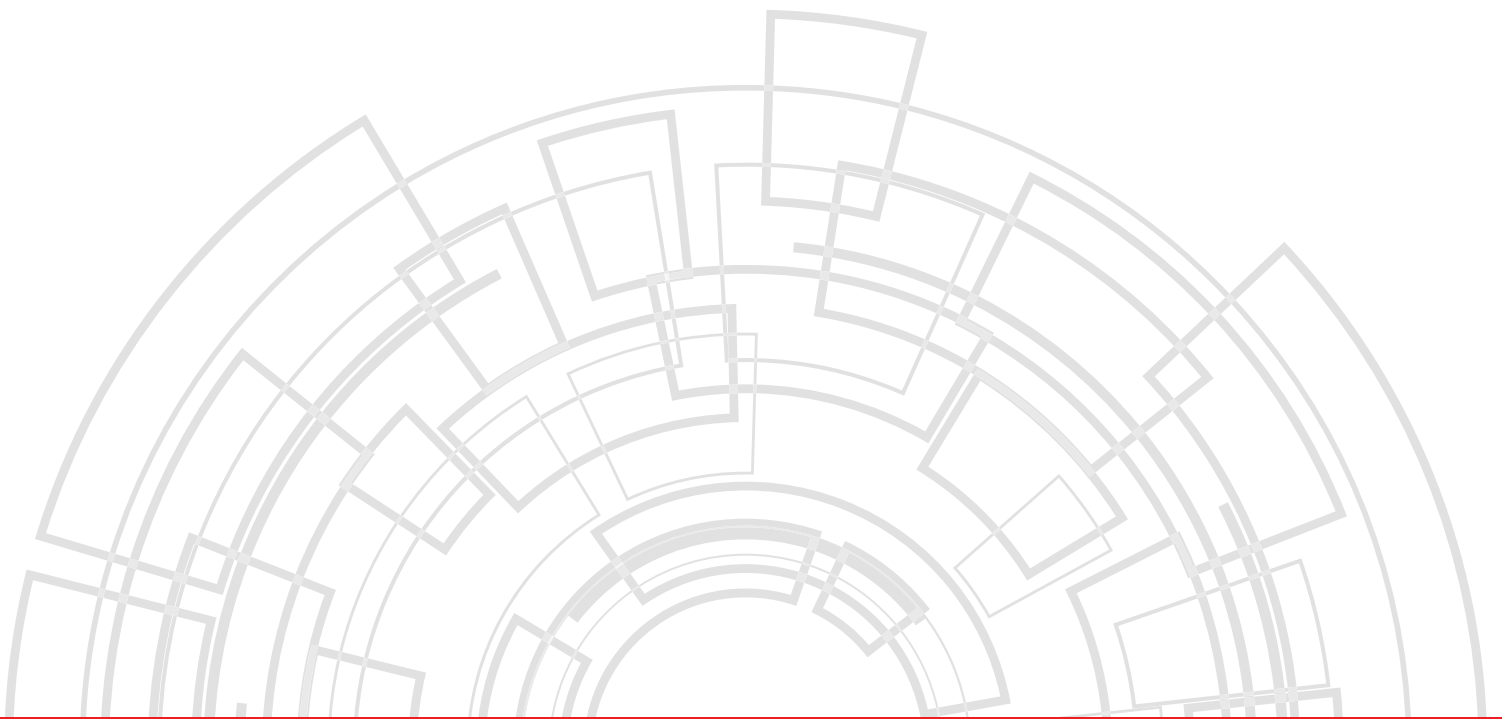

**Distributed by:**



**On Target Tooling, LLC  
P.O. Box 1026  
Menomonee Falls, WI 53052  
(p) 262-502-4480**